

**SPECIFICATION**  
 Current Rating: 1A AC/DC  
 Voltage Rating: 100V AC/DC  
 Withstanding Voltage: 500V AC/Minute  
 Contact Resistance: 20 Milliohms Max.  
 Insulation Resistance: 500 Megaohms Min.  
 ⚠ Temperature Range: -40°C ~ +105°C  
 Contact: Brass, Tin Plated Over Nickel  
 Insulation: PA66(UL94V-0), Gray  
 RoHS Compliant

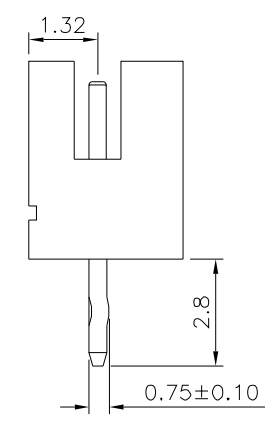
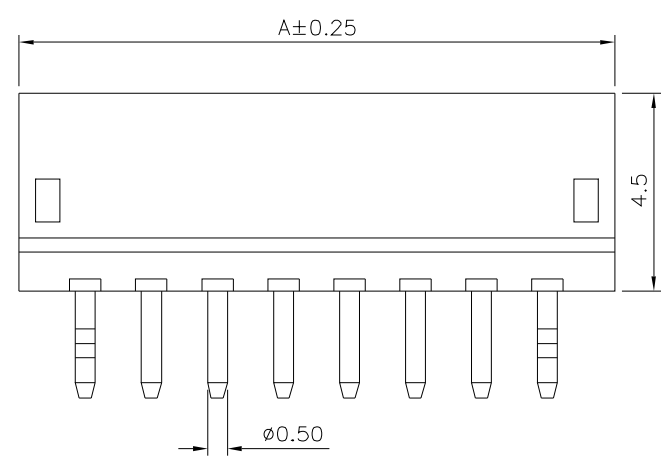
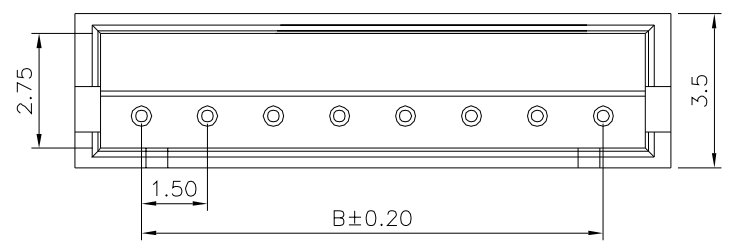

Pin	A	B
02	4.50	1.50
03	6.00	3.00
04	7.50	4.50
05	9.00	6.00
06	10.50	7.50
07	12.00	9.00
08	13.50	10.50
09	15.00	12.00
10	16.50	13.50
11	18.00	15.00
12	19.50	16.50
13	21.00	18.00

**4UCON** 元化興業股份有限公司  
4UCON TECHNOLOGY INC.

DRAWING No.		APPROVED BY		UNLESS OTHERWISE SPECIFIED TOLERANCES ARE .X ±0.30 .XX ±0.20 .XXX ±0.10 X.° ±2°
01313		MEI		
		CHECKED BY		
		HZF		
DRAWING BY		HAO		UNIT mm
SCALE	NONE	REV.	A1	

NO.	REV.	REVISIONS	CHK	DATE
⚠ A1		Modify Data	HZF	07/19/2021
⚠ A0		NEW RELEASE	HZF	07/04/2015