

SPECIFICATIONS
 Current Rating: 5 AMP
 Dielectric Withstanding Voltage:
 1000V Per Minute
 Insulation Resistance: 1000 Megohms Min.
 At 500V DC
 Contact Resistance: 15 Milliohms Max. 10 SES.
 Operating Temperature: -55°C ~ +105°C
 Insulator: PBT+30% Glass Fiber
 UL 94V-0
 Contact: Brass Or Phosphor Bronze
 Semi-Gold Plated 30u"
 Tin Plated

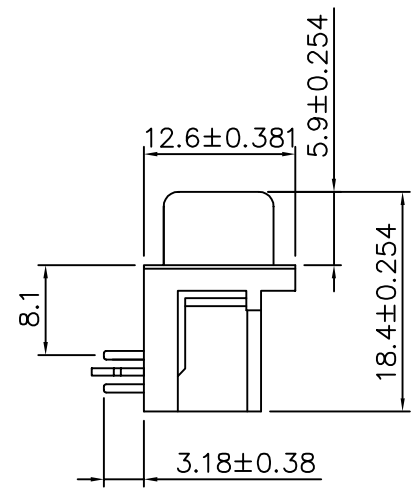
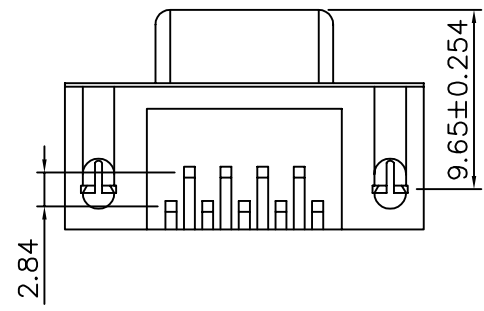
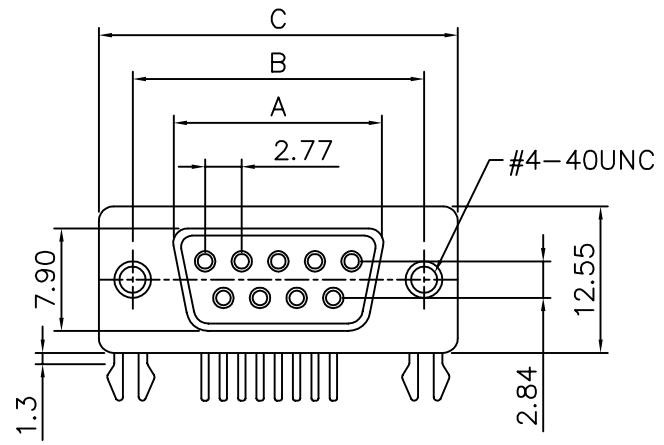

| Pin | A±0.20 | B±0.254 | C±0.381 |
|-----|--------|---------|---------|
| 09 | 16.33 | 24.99 | 30.81 |
| 15 | 24.66 | 33.32 | 39.14 |
| 25 | 38.38 | 47.04 | 53.04 |
| 37 | 54.84 | 63.50 | 69.32 |

4UCON 元化興業股份有限公司
 4UCON TECHNOLOGY INC.

| | | | | |
|-------------|------|-------------|---|--|
| DRAWING No. | | APPROVED BY | | UNLESS OTHERWISE SPECIFIED TOLERANCES ARE .X ±0.25 .XX ±0.15 .XXX ±0.05 |
| 02808 | | MEI | | |
| | | RAN | | |
| | | DRAWING BY | | |
| | | HZF | | |
| SCALE | NONE | REV. | A | UNIT mm |

| | | | |
|------|-----------|-----|------|
| AREA | REVISIONS | CHK | DATE |
| | | | |