

△ Recommended P.C.B. Layout

△△ SPECIFICATION

Current Rating: 3 Amperes  
 Voltage Rating: 800V AC 1 Minute  
 Contact Resistance: 20 Milliohms Max.  
 Insulation Resistance: 5000 Megaohms Min.  
 Operating Temperature: -55°C ~ +105°C  
 Insertion Force: 412 Grams Max. Per Pair  
 Withdrawal Force: 32 Grams Min. Per Pair  
 △ Insulator: PBT+G.F.(UL94V-0), Black  
 Contact: Phosphor Bronze, Gold Flash On Contact Area, Tin Plated On Solder Tails, Over Nickel  
 RoHS Compliant

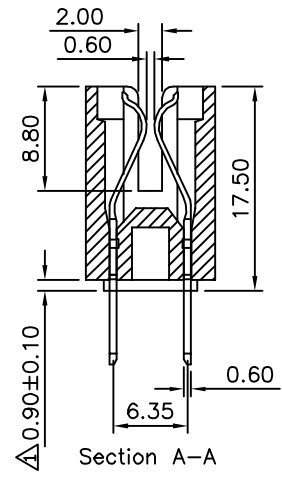
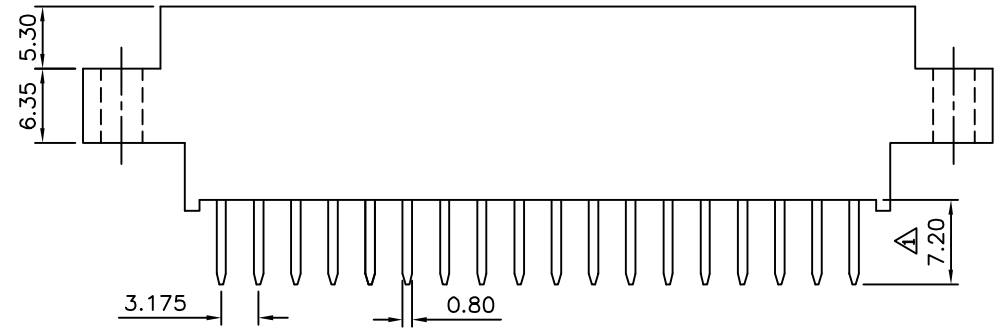
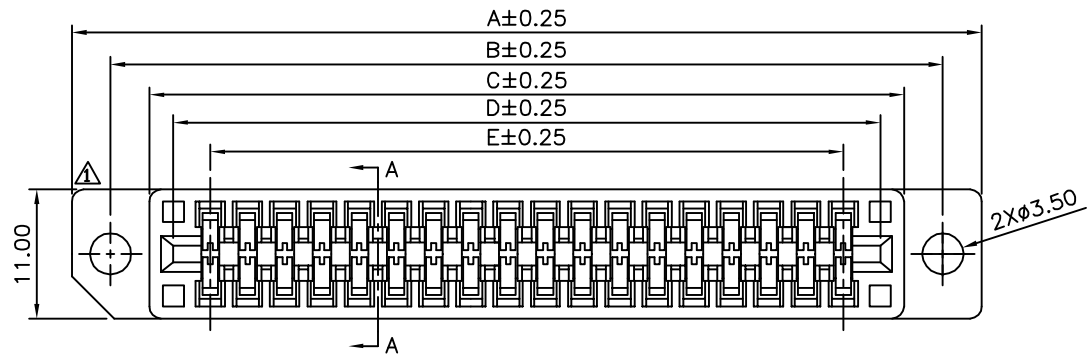

Pin	A	B	C	D	E
30	68.08	61.47	54.52	50.81	44.45
36	77.60	70.99	64.04	60.33	53.97
40	83.95	77.34	70.39	66.68	60.32
44	90.30	83.69	76.74	73.03	66.67
56	109.35	102.74	95.79	92.08	85.72
60	115.70	109.09	102.14	98.43	92.07
72	134.75	128.14	121.19	117.48	111.12
80	147.45	140.84	133.89	130.18	123.82
86	156.97	150.36	143.41	139.71	133.35
100	179.20	172.59	165.64	161.93	155.57

**4UCON** 元化興業股份有限公司  
 4UCON TECHNOLOGY INC.

DRAWING No.		APPROVED BY		UNLESS OTHERWISE SPECIFIED TOLERANCES ARE △△ X. ±0.50 .X ±0.38 .XX ±0.25
04626		MEI		
		CHECKED BY	HZF	
		DRAWING BY	SONG	
SCALE	NONE	REV.	A3	UNIT mm

NO.	REV.	REVISIONS	CHK	DATE
△	A3	Modify Data	HZF	03/05/2014
△	A2	Modify Data	HZF	07/31/2012
△	A1	Modify Data	HZF	09/01/2009
△	A0	NEW RELEASE	HZF	