

Dim. A	0.70X0.30	0.50X0.60	
Slot Option	Without Slot	With Slot	
Dim. X	4.0	2.5	13
		17	

SPECIFICATION

Current Rating:2 Amp
 Withstand Voltage:1000V AC For 1 Minute
 Contact Resistance:20 Milliohms Max. At 100mA DC
 Insulation Resistance:1000 Megaohms Min. At 500V DC
 Operation Temperature:-55°C~+125°C
 Insulator:PBT+30%G.F.(UL94V-0)
 Contact:Phosphor Bronze
 Boardlock:Phosphor Bronze,Tin Plated
 RoHS Compliant

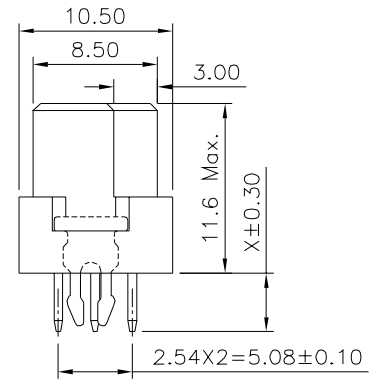
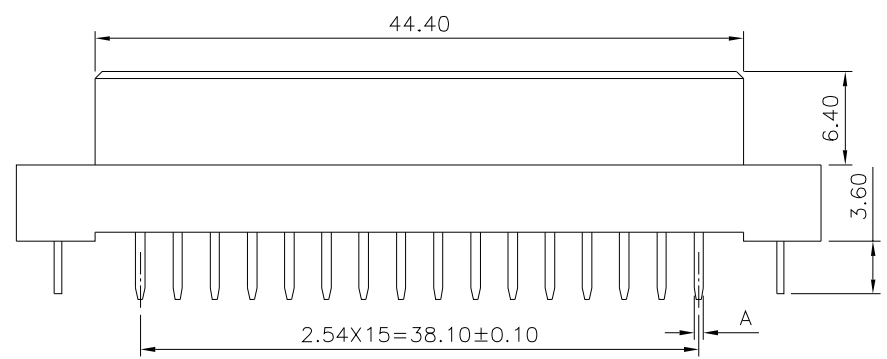

- (1) 16:Pin/Row,Full Pin (Pitch=2.54mm)
 8:Pin/Row,Removed Odd Pin (Pitch=5.08mm)
- (2) Boardlock Options(Standard W/O Boardlock)
- (3) DIP Length (Dim. X):
 X=4.0mm(Standard),or
 2.5mm,or 13.0mm,or 17.0mm
- (4) Contact Finish Option:

Standard:Gold Flash On Contact Area,
 Tin Plated On Solder Tails,Over Nickel
 2:Gold Plated 10u" On Contact Area,
 Tin Plated On Solder Tails,Over Nickel
 3:Gold Plated 15u" On Contact Area,
 Tin Plated On Solder Tails,Over Nickel
 6:Gold Plated 30u" On Contact Area,
 Tin Plated On Solder Tails,Over Nickel

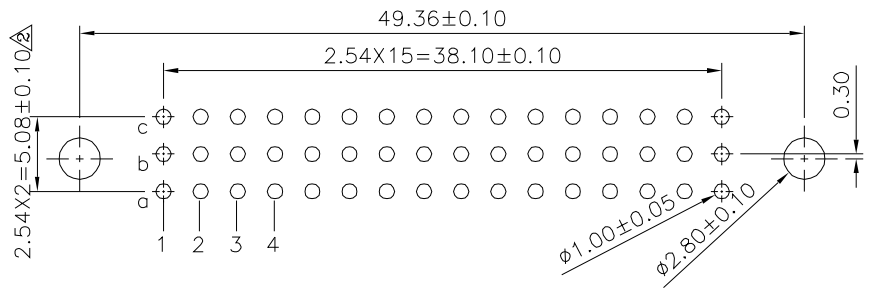

Recommended P.C.B. Layout
 PCB Tolerance:±0.05

Pitch	Pin	Rows With Contacts	Contact Arrange
2.54mm	48	a b c	
	32	a - c	
	16	a - -	
5.08mm	24	a b c	
	16	a - c	
	8	a - -	

4UCON 元化興業股份有限公司
 4UCON TECHNOLOGY INC.

DRAWING No.		APPROVED BY		UNLESS OTHERWISE SPECIFIED TOLERANCES ARE X. ±0.5 .X ±0.25 .XX ±0.15
05641		MEI		
		CHECKED BY	HZF	
		DRAWING BY	CYP	
SCALE	NONE	REV.	BO	UNIT mm

△ BO	NEW RELEASE	HZF	08/06/2019
NO.REV.	REVISIONS	CHK	DATE