

△ SPECIFICATION

Maximum Electric Current

A.W.G	22	20	18	16
Max. Amp	3	4	7	10

Max. Electrical Rating: 105°C 300V
 Reinforcement Sleeve: Easy-Entry Copper Sleeve
 Wire Range: 22-16 AWG/0.5-1.5mm²
 Insulator: PA66, Red
 Contact: Brass, Tin Plated Over Nickel
 RoHS Compliant

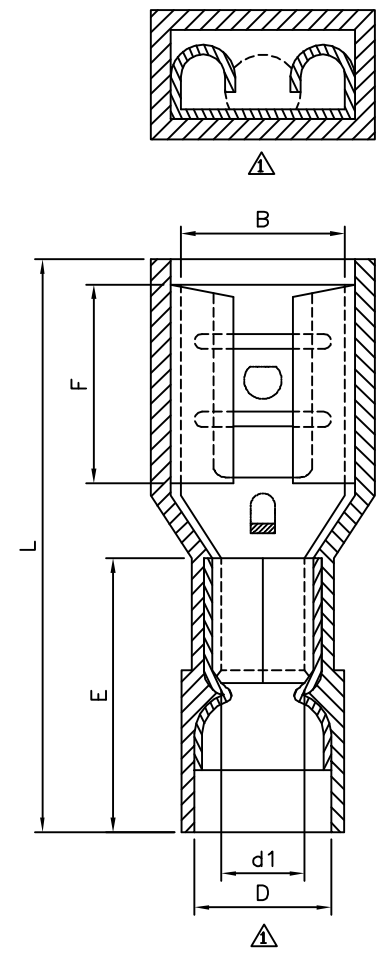

△ Item No.	Nema Tab	B±0.20	F±0.30	L±1.00	E±0.60	D±0.50	d1±0.20
05821	0.5x2.8	3.2	6.4	19.0	10.5	4.2	1.7

4UCON 元化興業股份有限公司
 4UCON TECHNOLOGY INC.

DRAWING No.		APPROVED BY		UNLESS OTHERWISE SPECIFIED TOLERANCES ARE .X ±0.38 .XX ±0.25 ANG.
05821		EMILY		
		CHECKED BY		
		HZF		
		DRAWING BY		
		HTP		
SCALE	NONE	REV.	A1	UNIT
				mm

NO.	REV.	REVISIONS	CHK	DATE
△ A1		Modify Data	HZF	03/09/2012
△ A0		NEW RELEASE	BECKY	01/12/2005