

**△△△ SPECIFICATION**

△ Material: Phosphor Bronze, Tin Plated Over Nickel  
 Q'ty: 30000 PCS/Reel  
 RoHS Compliant

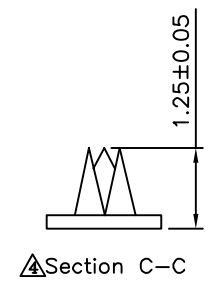
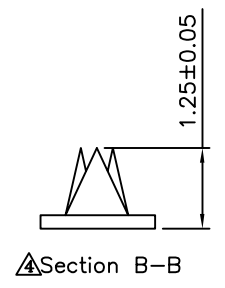
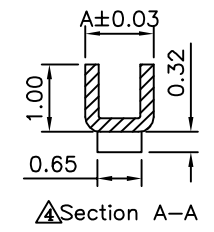
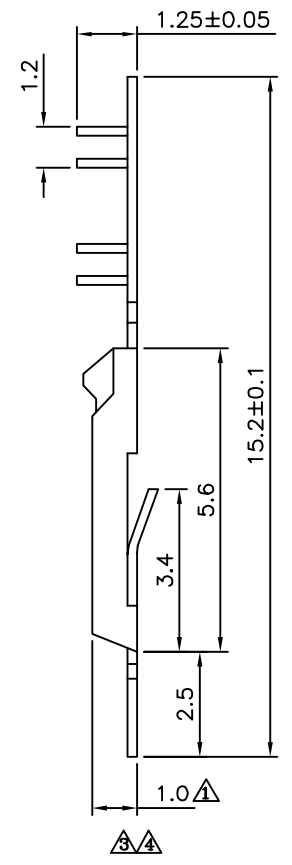
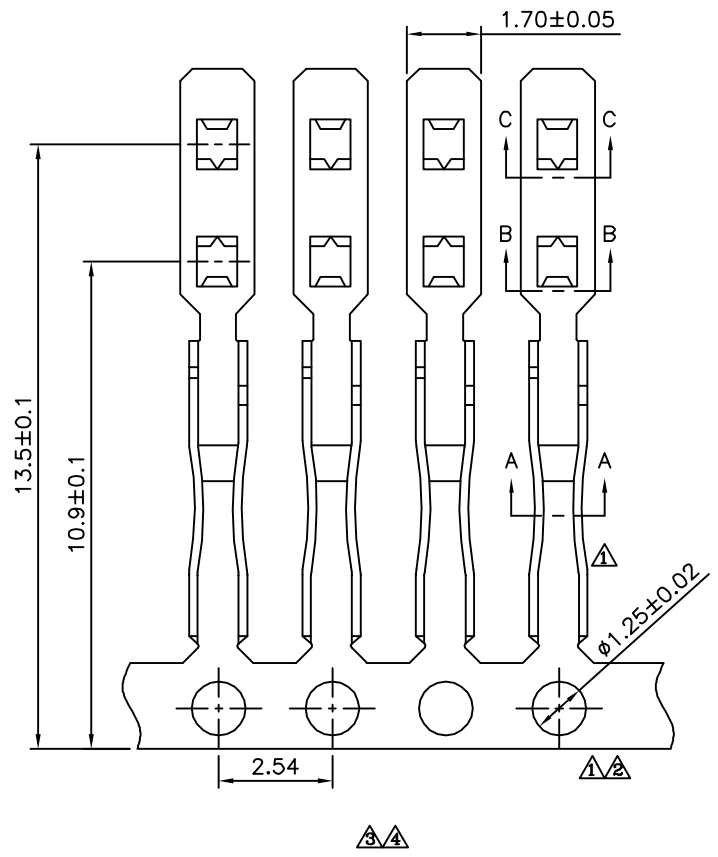

Item No.	A	Mating Housing
07140	0.81	1X02~1X12, 2X01~2X06
20151	0.91	1X13~1X40, 2X07~2X25

**4UCON** 元化興業股份有限公司  
 4UCON TECHNOLOGY INC.

DRAWING No.		APPROVED BY		UNLESS OTHERWISE SPECIFIED TOLERANCES ARE X. ±0.5 △△.X ±0.25 .XX ±0.2 .XXX ±0.08
07140		EMILY		
		CHECKED BY HZF		
		DRAWING BY GAO		
SCALE	NONE	REV.	A4	UNIT mm

NO.	REV.	REVISIONS	CHK	DATE
△	A4	Modify Data	HZF	05/15/2013
△	A3	Modify Data	HZF	06/30/2010
△	A2	Modify Dim.&Spec.&Add Spec.	BECKY	07/06/2005
△	A1	Add Dim.&Modify Spec.	BECKY	07/01/2005
△	A	NEW RELEASE	RAN	12/13/2002