

△ Recommended P.C.B. Layout

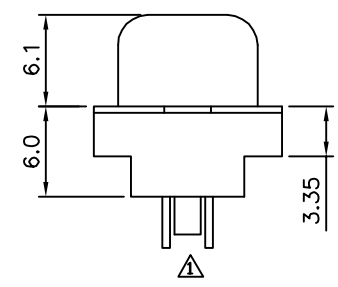
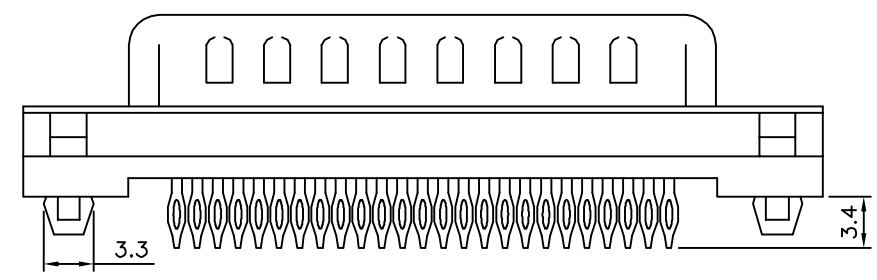
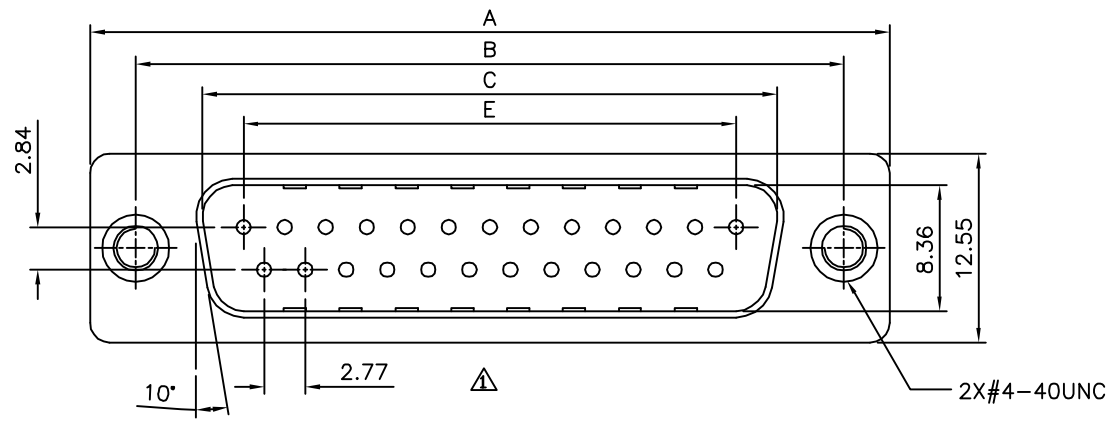

△ SPECIFICATION

Current Rating:3A  
 Volatge Rating:250V AC/RMS 60Hz  
 Contact Resistance:20 Milliohms Max.  
 At 1 Amp DC  
 Insulation Resistance:1000 Megaohms Min.  
 At 500V DC  
 Dielectric Withstanding Voltage:  
 1000V AC/RMS 60Hz For 1 Minute  
 Housing:PBT+G.F.(UL94V-0),Black  
 Contact:Phosphor Bronze,Gold Flash On Contact Area,  
 Tin Plated On Solder Tails,Over Nickel  
 Shell:Steel,Tin Plated Over Copper  
 Boarlock:Brass,Tin Plated  
 RoHS Compliant

Pin	A	B	C	E
09	30.81	24.99	16.92	11.08
15	39.14	33.32	25.25	19.39
25	53.04	47.04	38.96	33.24
37	69.32	63.50	55.42	49.86

**4UCON** 元化興業股份有限公司  
 4UCON TECHNOLOGY INC.

DRAWING No.		APPROVED BY		UNLESS OTHERWISE SPECIFIED TOLERANCES ARE △ X. ±0.38 X.' ±3" .X ±0.25 .X' ±1.0" .XX ±0.13
07927		EMILY		
		CHECKED BY		
		HZF		
		DRAWING BY		
		HAO		
SCALE	NONE	REV.	A1	UNIT
				mm

△ A1	Modify Data	HZF	05/14/2015
△ A0	NEW RELEASE		
NO.REV.	REVISIONS	CHK	DATE