

**Specifications**

Current Rating: 1A AC,DC  
 Voltage Rating : 50V AC DC  
 Temperature Range : -25°C to +85°C  
 Insulation Resistance: 500Megohms Min.  
 Contact Resistance: 20Milliohms Max.  
 Withstanding Voltage : 500V AC/Minute  
 Pin Material : Brass/Tin plated  
 Solder Tabs : Brass/Tin plated  
 Wafer : Nylon 6T, UL 94V-0

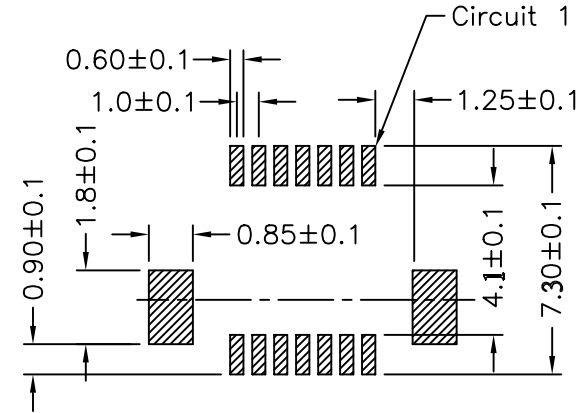

PCB LAYOUT

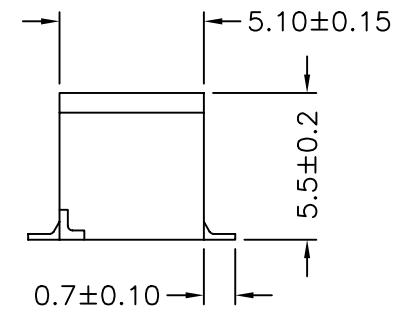
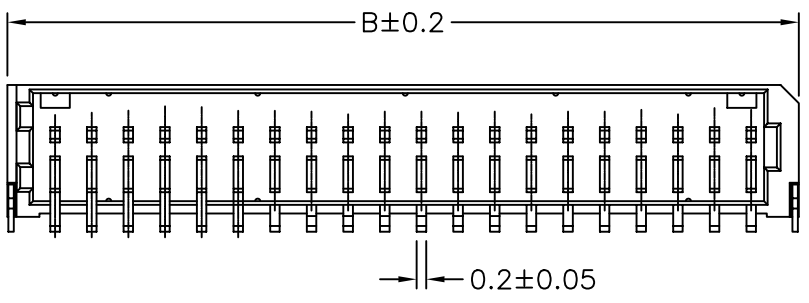
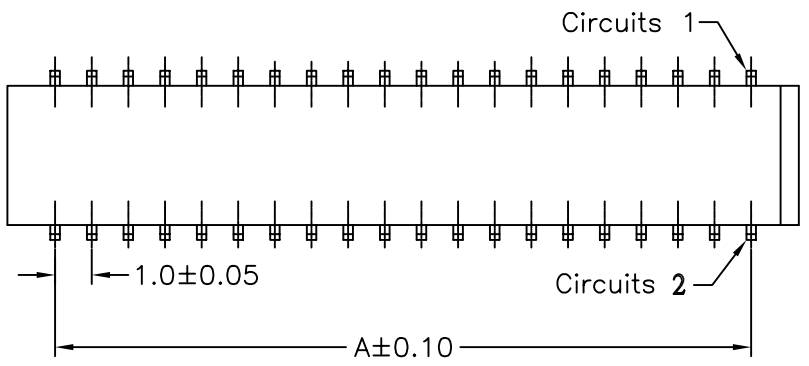

POS.#	DIM. A	DIM. B
2x10P	9.00	13.10
2X15P	14.00	18.10
2x20P	19.00	23.10
2X25P	24.00	28.10

**4UCON** 元化興業股份有限公司  
 4UCON TECHNOLOGY INC.

DRAWING No.  
 09892

APPROVED BY MEI  
 CHECKED BY RAN  
 DRAWING BY HZF

UNLESS OTHERWISE SPECIFIED TOLERANCES ARE  
 .X ±0.38  
 .XX ±0.25  
 ANG.

SCALE NONE REV. A UNIT mm

AREA REVISIONS CHK DATE