

SPECIFICATION
 Current Rating:3A AC/DC
 Voltage Rating:250V AC/DC
 Dielectric Withstanding Voltage:1500V AC/Minute
 Ambient Temperature Range:-40°C~+105°C
 Insulator:PA66(UL94V-0),Brown
 Pin:Brass,Tin Plated
 RoHS Compliant

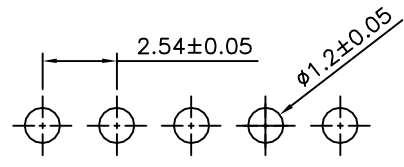

Recommended P.C.B. Layout

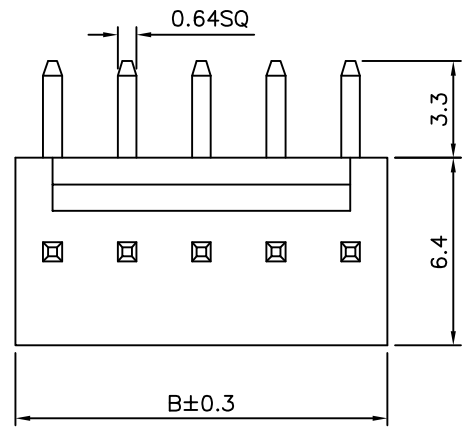
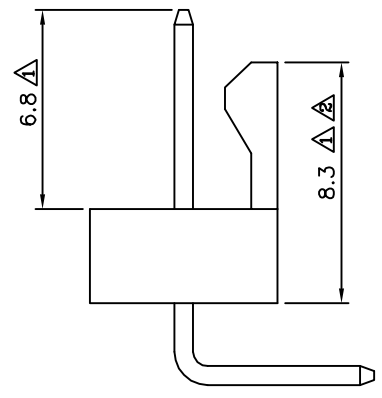
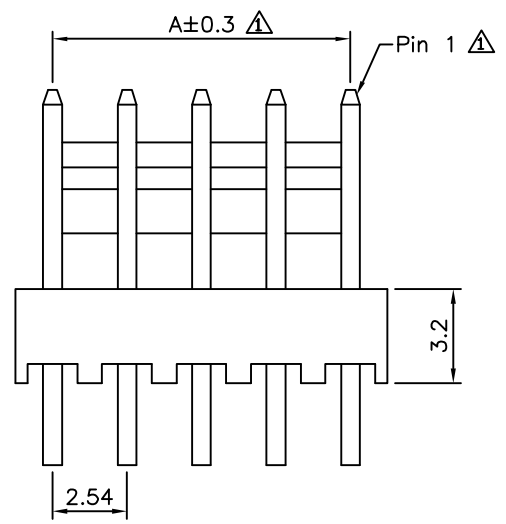

Circuits	A	B
2	2.54	5.08
3	5.08	7.62
4	7.62	10.16
5	10.16	12.70
6	12.70	15.24
7	15.24	17.78
8	17.78	20.32
9	20.32	22.86
10	22.86	25.40
11	25.40	27.94
12	27.94	30.48
13	30.48	33.02
14	33.02	35.56
15	35.56	38.10
16	38.10	40.64
17	40.64	43.18
18	43.18	45.72
19	45.72	48.26
20	48.26	50.80

4UCON 元化興業股份有限公司
 4UCON TECHNOLOGY INC.

DRAWING No.		APPROVED BY		UNLESS OTHERWISE SPECIFIED TOLERANCES ARE .X ±0.25 .XX ±0.15 .XXX ±0.05
09920		EMILY		
		CHECKED BY		
		HZF		
		DRAWING BY		
		QQJ		
SCALE	NONE	REV.	A2	UNIT
				mm

NO.	REV.	REVISIONS	CHK	DATE
△A2		Modify Data	HZF	06/25/2014
△A1		Modify Data	HZF	11/24/2010
△A0		NEW RELEASE		