

Recommended P.C.B. Layout
PCB Board Thickness:1.6mm

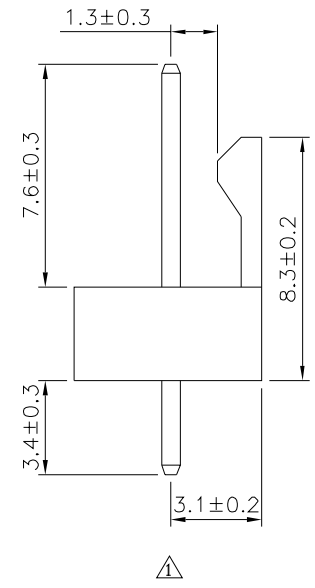
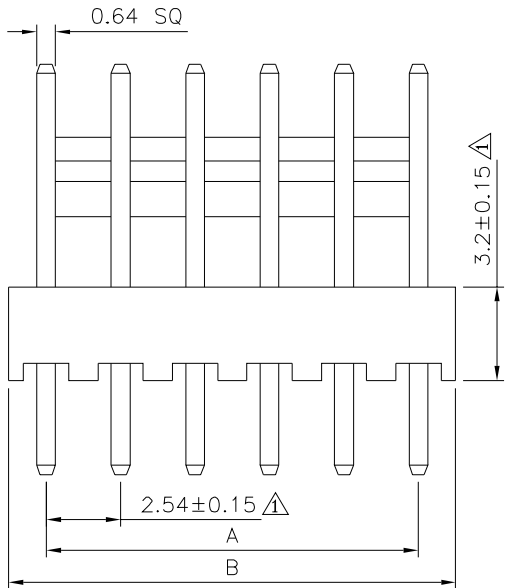
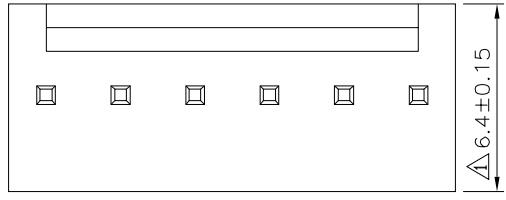

△△ SPECIFICATION
 Current Rating: 3A AC/DC
 Voltage Rating: 250V AC/DC
 Insulation Resistance: 1000 Megaohms Min.
 Contact Resistance: 20 Milliohms Max.
 Withstand Voltage: 1000V AC/Minute
 Temperature Range: -25°C~+85°C
 Insulator: PA66(UL94V-0),Brown
 Contact: Brass, Tin Plated
 RoHS Compliant

Pin	A	B
2	2.54	5.10
3	5.08	7.68
4	7.62	10.24
5	10.16	12.78
6	12.70	15.24
7	15.24	17.88
8	17.78	20.44
9	20.32	23.00
10	22.86	25.54
11	25.40	28.10
12	27.94	30.64
13	30.48	33.20
14	33.02	35.74
15	35.56	38.30
16	38.10	40.84
17	40.64	43.40
18	43.18	45.94
19	45.72	48.50
20	48.26	51.05

△ Dim. A,B Tolerance As Follow:

Pin	A	B
2~5	±0.15	±0.15
6~8	±0.20	±0.25
9~20	±0.30	±0.35

4UCON 元化興業股份有限公司
4UCON TECHNOLOGY INC.

DRAWING No. △△
09928

APPROVED BY MEI
 CHECKED BY HZF
 DRAWING BY CYP

UNLESS OTHERWISE SPECIFIED TOLERANCES ARE
 X. ±0.5
 .X ±0.25
 .XX ±0.2
 .XXX ±0.08

SCALE NONE

REV. B3

UNIT mm

NO.	REV.	REVISIONS	CHK	DATE
△	B3	Modify Data	HZF	05/26/2018
△	B2	Modify Data	HZF	06/15/2015
△	B1	Modify Data	HZF	08/27/2010
△	B0	NEW RELEASE	HZF	05/02/2007