

△ SPECIFICATION

Current Rating:3 Amps/Contact Max.
 Operation Voltage:60V AC/DC
 Contact Resistance:4 Milliohms Max.
 Insulation Resistance:1000 Megaohms Min. At 100V
 Operation Temperature:Gold Plated:-55°C~+105°C
 Tin Plated:-40°C~+105°C
 Housing:PPS(UL94V-0),Black
 Pin(Outer Sleeve):Brass,Tin Plated Over Nickel
 Clip(Contact 6 Finger):Beryllium Copper
 Gold Flash Over Nickel
 Average Insertion Force With Steel Pin Of $\phi 0.43\text{mm}$:<75g
 Average Withdrawal Force With Steel Pin Of $\phi 0.43\text{mm}$:>25g
 Mechanical Life Cycle:200 Min.
 RoHS Compliant

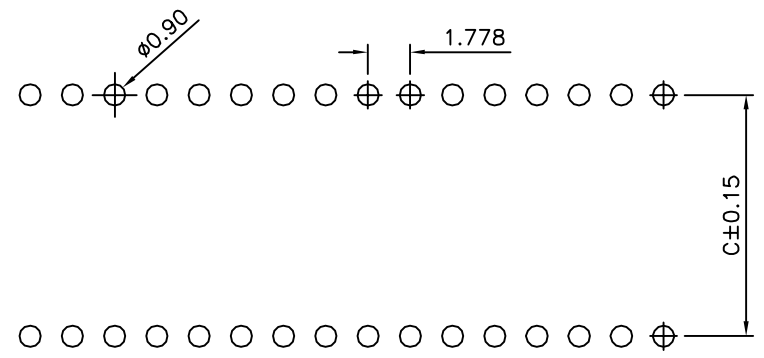

Recommended P.C.B. Layout

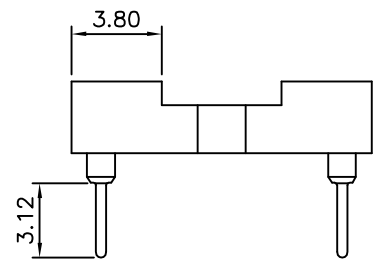
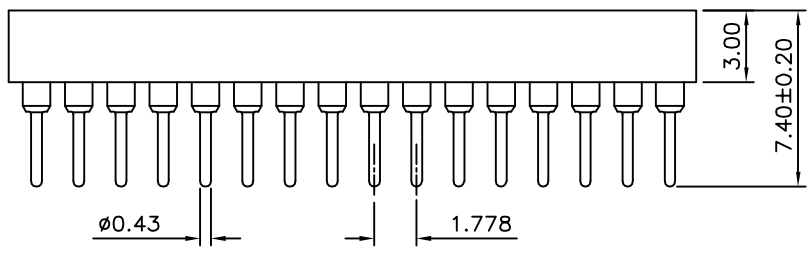
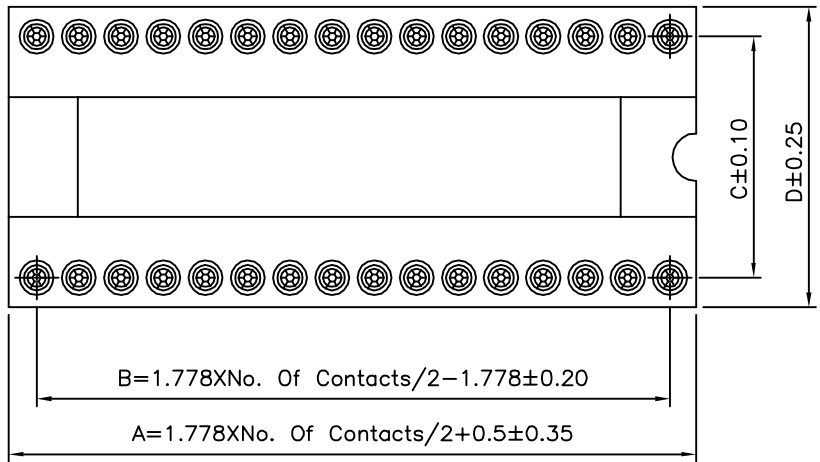

Pin	A	B	C	D
20	18.28	16.002	15.24	17.73
24	21.836	19.558		
28	25.392	23.114		
32	28.948	26.67		
40	36.06	33.782		
42	37.838	35.560		
48	43.172	40.894		
52	46.728	44.45		
56	50.284	48.006		
64	57.396	55.118		
68	60.952	58.674		

4UCON 元化興業股份有限公司
 4UCON TECHNOLOGY INC.

DRAWING No. 10201

APPROVED BY EMILY
 CHECKED BY HZF
 DRAWING BY HAO

UNLESS OTHERWISE SPECIFIED TOLERANCES ARE
 X. ±0.50
 .X ±0.30
 .XX ±0.20
 .XXX ±0.10
 ANG. ±5°

NO.	REV.	REVISIONS	CHK	DATE
△ A1		Modify Data	HZF	06/01/2015
△ A0		NEW RELEASE	HZF	03/27/2013

SCALE NONE REV. A1

