

Recommended P.C.B. Layout

**SPECIFICATION**

Current Rating:1.5 Ampere Per Contact  
 Contact Resistance:30 Milliohms Max.  
 Insulation Resistance:1000 Megaohms Min.  
 Dielectric Withstanding Voltage:500V DC  
 Operation Temperature:-20°C~+85°C  
 Housing:LCP(UL94V-0),Black  
 Contact:Copper Alloy  
 Gold Plated 15u" On Contact Area,Misty Tin  
 Plated On Solder Tail,Under Nickel  
 Boardlock:Copper Alloy,Matte Tin Plated Over Nickel  
 RoHS Compliant

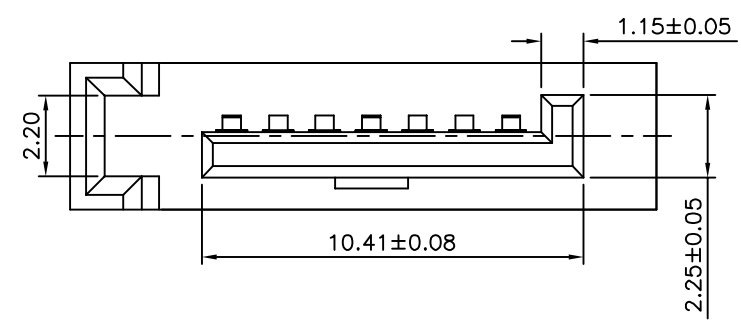
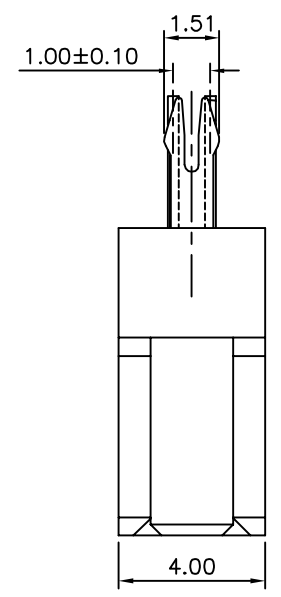
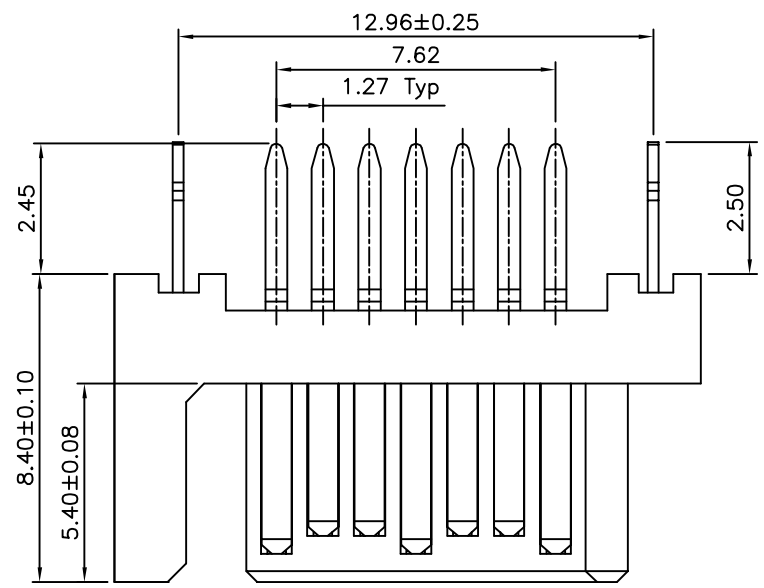

**4UCON** 元化興業股份有限公司  
 4UCON TECHNOLOGY INC.

DRAWING No.		APPROVED BY		UNLESS OTHERWISE SPECIFIED TOLERANCES ARE .X ±0.20 .XX ±0.15 ANG. ±1°
14500		EMILY		
		CHECKED BY		
		HZF		
		DRAWING BY		
		SONG		
SCALE	NONE	REV.	A0	UNIT mm

NO.	REV.	REVISIONS	CHK	DATE
△ A0		NEW RELEASE	HZF	12/02/2010