

**△△ SPECIFICATION**  
 Current:7.0A Max.  
 Voltage:250V Max.  
 Withstanding Voltage:1500V  
 Insulation Resistance:500K Megaohms Min.  
 Temperature Range:-40°C~+105°C  
 △△ Housing:PA66(UL94V-2),White  
 △△ Contact:Brass,Tin Plated Over Nickel  
 RoHS Compliant

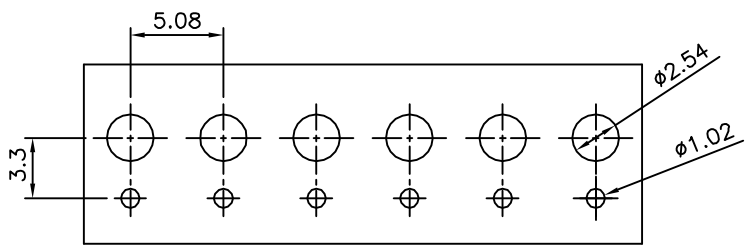

Recommended P.C.B. Layout

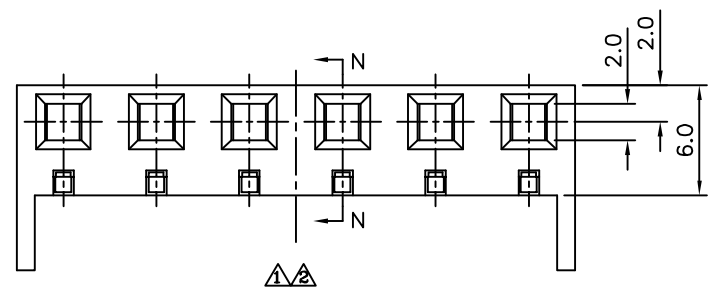

△△

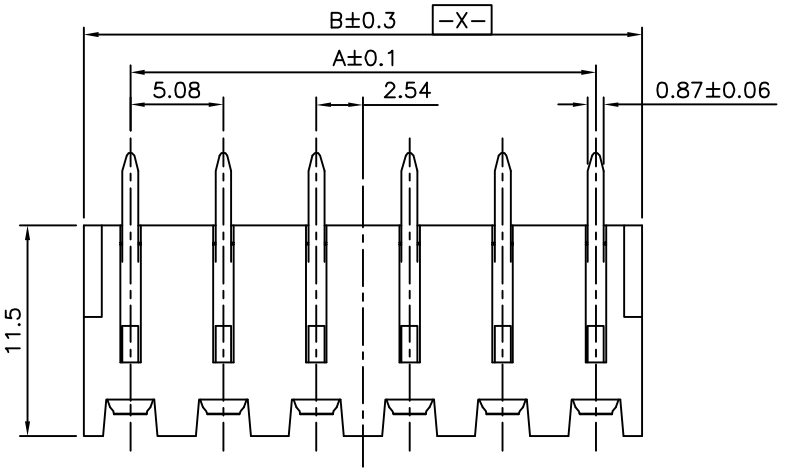

△△

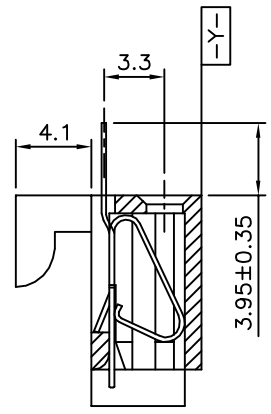

△△ Section:N-N

△△ Circuit	A	B
2	5.08	10.16
3	10.16	15.24
4	15.24	20.32
5	20.32	25.40
6	25.40	30.48
7	30.48	35.56
8	35.56	40.64
9	40.64	45.72
10	45.72	50.80
11	50.80	55.88
12	55.88	60.96

**4UCON** 元化興業股份有限公司  
 4UCON TECHNOLOGY INC.

DRAWING No.		APPROVED BY		UNLESS OTHERWISE SPECIFIED TOLERANCES ARE △.X ±0.30 X.* ±1* .XX ±0.20 .X* ±0.5* .XXX ±0.10 .XX* ±0.25*
14933		MEI		
		CHECKED BY		
		HZF		
		DRAWING BY		
		HAO		
SCALE	NONE	REV.	A3	UNIT mm

NO.	REV.	REVISIONS	CHK	DATE
△△ A3		Modify Data	HZF	05/20/2015
△△ A2		Modify Data	HZF	06/01/2012
△△ A1		Modify Data	HZF	05/26/2010
△△ A0		NEW RELEASE	BECKY	2004/06/07