

△△ SPECIFICATION
 Current:7.0A Max.
 Voltage:250V Max.
 Withstanding Voltage:1500V
 Insulation Resistance:500K Megaohms Min.
 Temperature Range:-40°C~+105°C
 △△ Housing:PA66(UL94V-2),White
 △△ Contact:Brass,Tin Plated Over Nickel
 RoHS Compliant

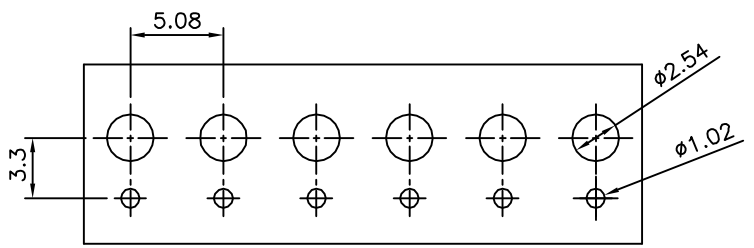

Recommended P.C.B. Layout

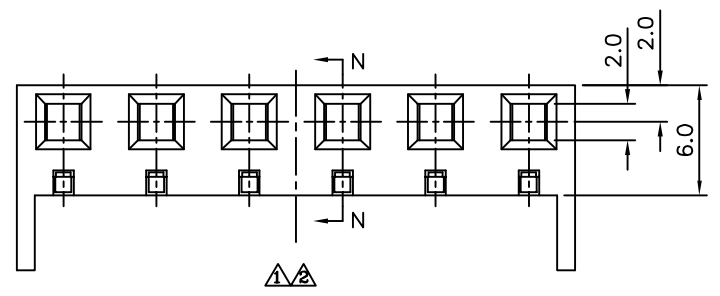

△△

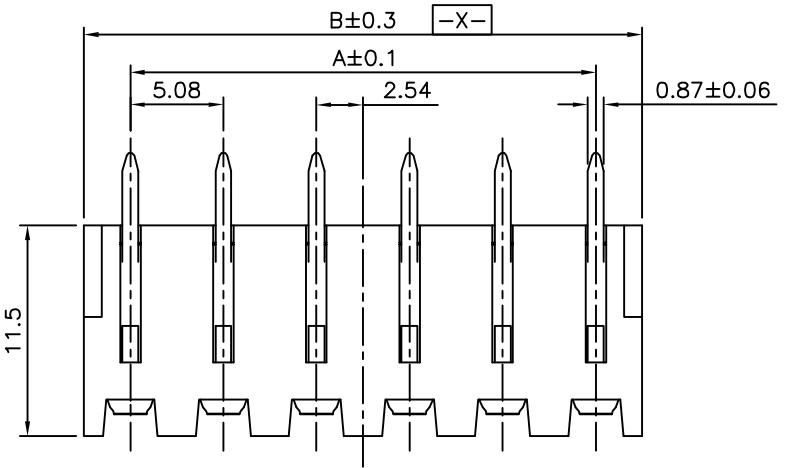

△△

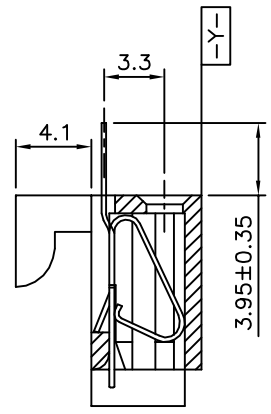

△△ Section:N-N

| △△ Circuit | A | B |
|------------|-------|-------|
| 2 | 5.08 | 10.16 |
| 3 | 10.16 | 15.24 |
| 4 | 15.24 | 20.32 |
| 5 | 20.32 | 25.40 |
| 6 | 25.40 | 30.48 |
| 7 | 30.48 | 35.56 |
| 8 | 35.56 | 40.64 |
| 9 | 40.64 | 45.72 |
| 10 | 45.72 | 50.80 |
| 11 | 50.80 | 55.88 |
| 12 | 55.88 | 60.96 |

4UCON 元化興業股份有限公司
 4UCON TECHNOLOGY INC.

DRAWING No. 14935

APPROVED BY MEI
 CHECKED BY HZF
 DRAWING BY HAO

UNLESS OTHERWISE SPECIFIED TOLERANCES ARE
 △.X ±0.30 X.* ±1*
 .XX ±0.20 .X* ±0.5*
 .XXX ±0.10 .XX* ±0.25*

| SCALE | NONE | REV. | A3 | UNIT | mm | NO. REV. | REVISIONS | CHK | DATE |
|-------|------|------|----|------|----|----------|-----------|-----|------|
| | | | | | | | | | |

| △△ | NO. | REV. | REVISIONS | CHK | DATE |
|----|-----|------|-------------|-------|------------|
| △ | A3 | | Modify Data | HZF | 05/20/2015 |
| △ | A2 | | Modify Data | HZF | 06/01/2012 |
| △ | A1 | | Modify Data | HZF | 05/26/2010 |
| △ | A0 | | NEW RELEASE | BECKY | 2004/06/07 |