

Recommended P.C.B. Layout(Top View)
(PCB Board Tolerance ± 0.05)

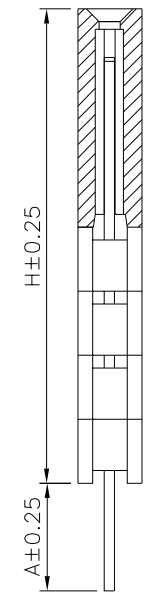
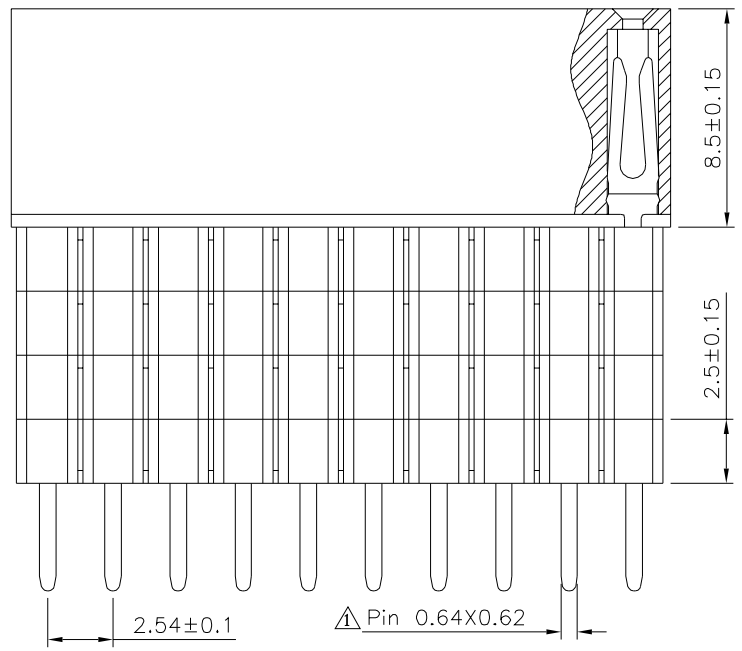
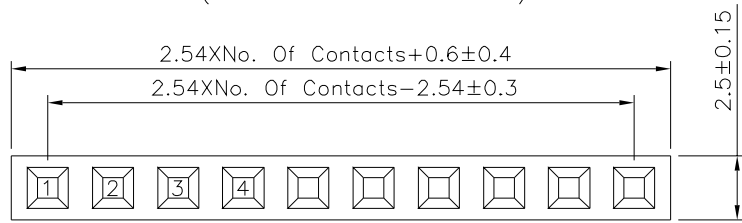

SPECIFICATION

Current Rating:3A
 Withstand Voltage:1000V AC Min./Minute
 Contact Resistance:20 Milliohms Max.
 Insulation Resistance:1000 Megohms Min.
 Operating Temperature:-40°C~+105°C
 Δ Insulator:PA9T(UL94V-0),Black
 Contact:Brass,Gold Flash Over Nickel
 RoHS Compliant

| Series No. | Plastic Q'ty | H | A |
|------------|--------------|-------|-------|
| 0196 | 1 | 11.00 | 2.30 |
| 0196 | 1 | 11.00 | 7.00 |
| 0196 | 1 | 11.00 | 12.30 |
| 0197 | 2 | 13.50 | 4.50 |
| 0197 | 2 | 13.50 | 9.80 |
| 0198 | 3 | 16.00 | 2.00 |
| 0198 | 3 | 16.00 | 7.30 |
| 0199 | 4 | 18.50 | 4.80 |

4UCON 元化興業股份有限公司
 4UCON TECHNOLOGY INC.

| | | | | |
|-------------|------|-------------|----|--|
| DRAWING No. | | APPROVED BY | | UNLESS OTHERWISE SPECIFIED TOLERANCES ARE Δ |
| 15281 | | EMILY | | |
| | | CHECKED BY | | |
| | | HZF | | X. ± 0.30 X. $\pm 2^{\circ}$.X ± 0.25 .X $\pm 1.5^{\circ}$.XX ± 0.20 .XX $\pm 1^{\circ}$.XXX ± 0.15 .XXX $\pm 0.5^{\circ}$ |
| | | DRAWING BY | | |
| | | HAO | | |
| SCALE | NONE | REV. | A1 | UNIT |
| | | | | mm |

| | | | | |
|-------------|------|-------------|-----|------------|
| NO. | REV. | REVISIONS | CHK | DATE |
| Δ A1 | | Modify Data | HZF | 03/28/2025 |
| Δ A0 | | NEW RELEASE | HZF | 12/11/2014 |