

△ SPECIFICATION
 Current Rating:1 Amps
 Voltage Rating:250V AC
 Withstanding Voltage:500V(One Minute)
 Contact Resistance:30 Milliohms Max.
 Insulation Resistance:1000 Megaohms Min.
 At 500V DC
 Operating Temperature:-55°C~+105°C
 Shell:Steel,Nickel Plated
 Insulator:PBT+30%G.F.(UL94V-0),Black
 Contact:Brass
 Gold Flash On Contact Area,
 Tin Plated On Solder Tails,Over Nickel
 Rivet:Brass,Nickel Plated
 Z Flake:Steel,Tin Plated
 Screw:Steel,Nickel Plated
 RoHS Compliant

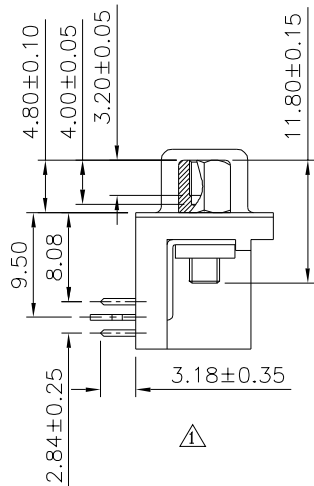
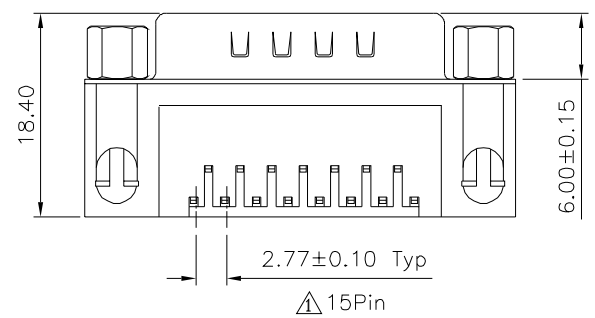
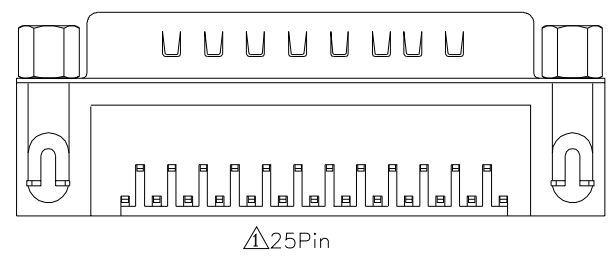
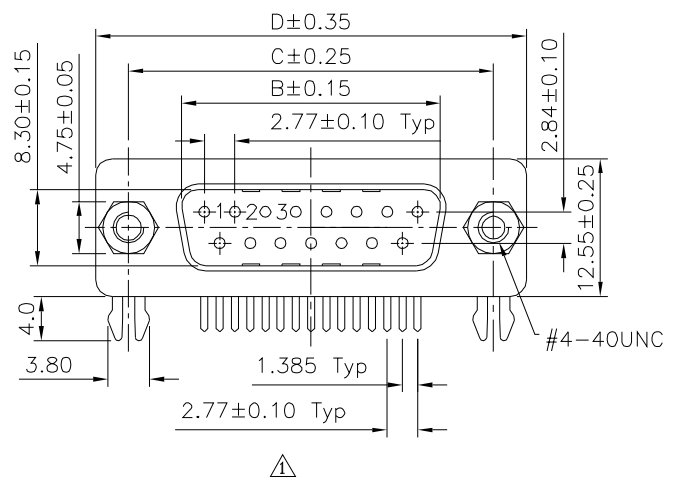
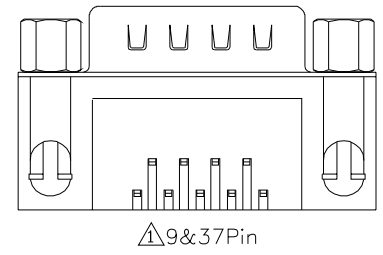
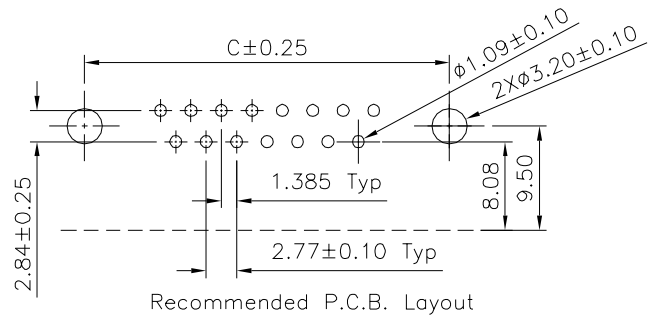

Pin	B	C	D
09	16.92	24.99	30.81
15	25.25	33.32	39.20
25	38.96	47.04	53.04
37	55.42	63.50	69.40

4UCON 元化興業股份有限公司
 4UCON TECHNOLOGY INC.

DRAWING No.		APPROVED BY		UNLESS OTHERWISE SPECIFIED TOLERANCES ARE .X ±0.38 .X* ±3* .XX ±0.25 .XX* ±1* .XXX ±0.05 .XXX* ±0.5*
18606		MEI		
		CHECKED BY	HZF	
		DRAWING BY	CYP	
SCALE	NONE	REV.	B1	UNIT mm

NO.	REV.	REVISIONS	CHK	DATE
△ B1		Modify Data	HZF	08/04/2021
△ B0		NEW RELEASE	HZF	05/15/2015