

Recommended P.C.B. Layout(Top Side)
(PCB Board Tolerance±0.05)

- △ SPECIFICATION**
- Current Rating:3.0 Amp
 - Withstand Voltage:1000V AC/DC
 - △ Contact Resistance:20 Milliohms Max.
 - Insulation Resistance:1000 Megaohms Min.
 - Operation Temperature:-40°C~+105°C
 - △ Contact:Phosphor Bronze,Gold Plated Over Nickel
 - Insulator:PBT+30%G.F.(UL94V-0),Black
 - RoHS Compliant

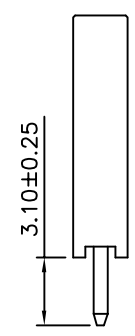
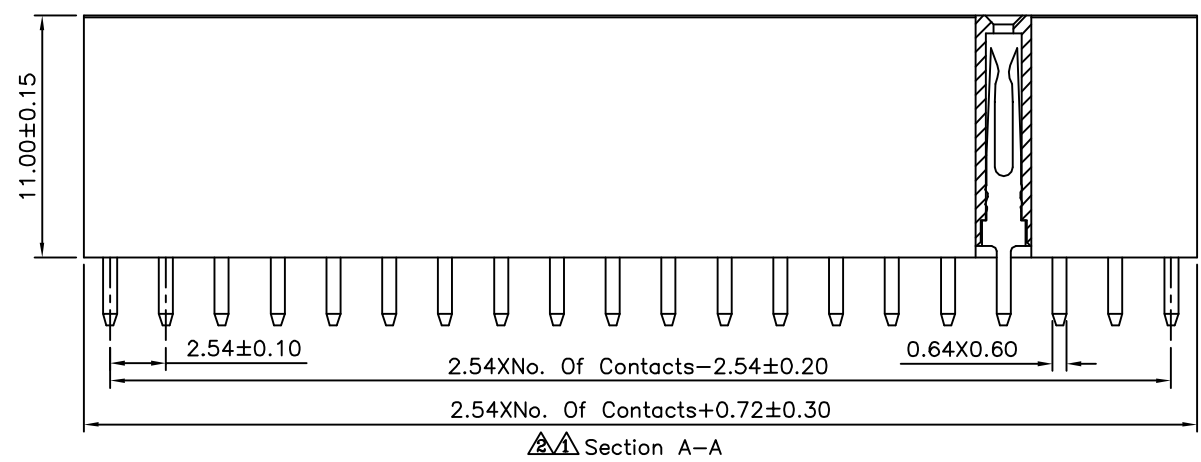
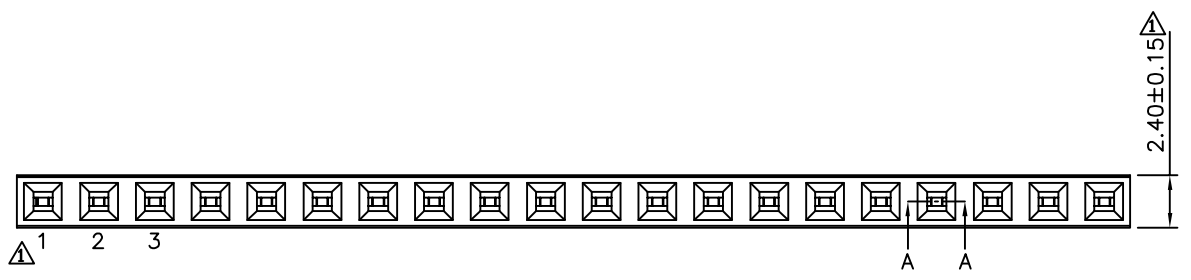

4UCON 元化興業股份有限公司
4UCON TECHNOLOGY INC.

DRAWING No.		APPROVED BY		UNLESS OTHERWISE SPECIFIED TOLERANCES ARE .X ±0.40 .XX ±0.25 .XXX ±0.15 ANG. ±3°
19606		EMILY		
		CHECKED BY HZF		
		DRAWING BY GAO		
SCALE	NONE	REV.	A2	UNIT mm

NO.	REV.	REVISIONS	CHK	DATE
△ A2		Modify Data	HZF	03/21/2013
△ A1		Modify Data	HZF	08/10/2011
△ A0		NEW RELEASE	HZF	08/04/2008