

**SPECIFICATION**  
 Voltage Rating:100V AC/DC  
 Current Rating:1.0 Amp  
 Withstand Voltage:500V AC/DC  
 Contact Resistance:20 Milliohms Max.  
 Insulation Resistance:100 Megaohms Min.  
 Operation Temperature:-25°C~+85°C  
 Contact:Brass,Gold Plated Over Nickel  
 Insulator:PA6T+30%G.F.(UL94V-0),Black  
 RoHS Compliant

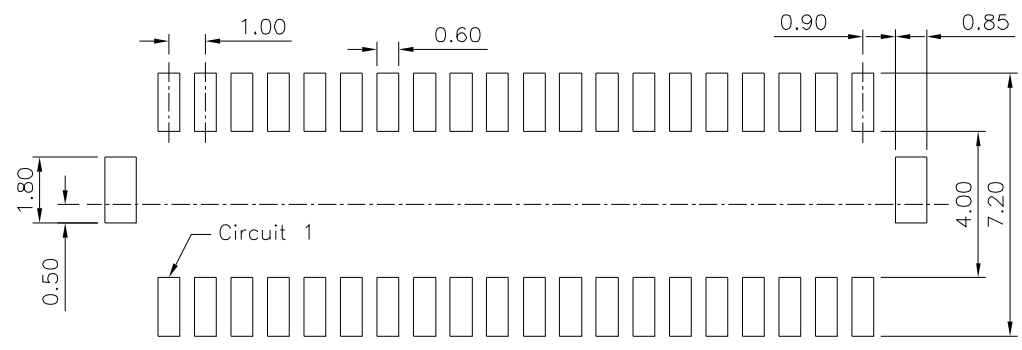

Recommended P.C.B. Layout(Top Side)  
 (PCB Board Tolerance±0.05)

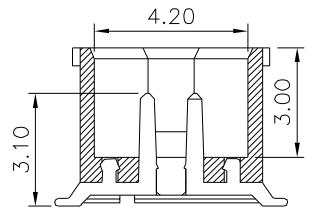
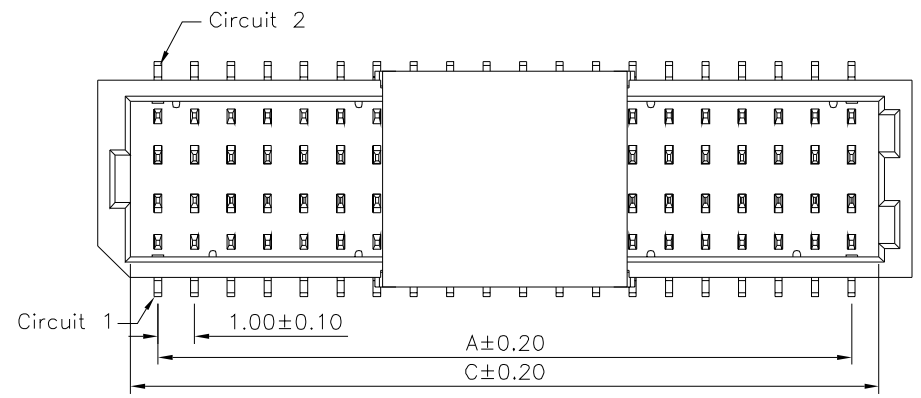

Section A-A

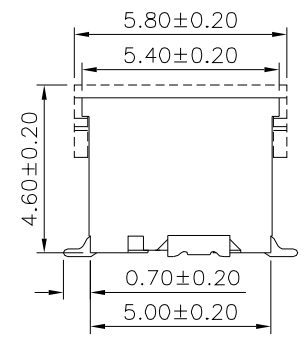
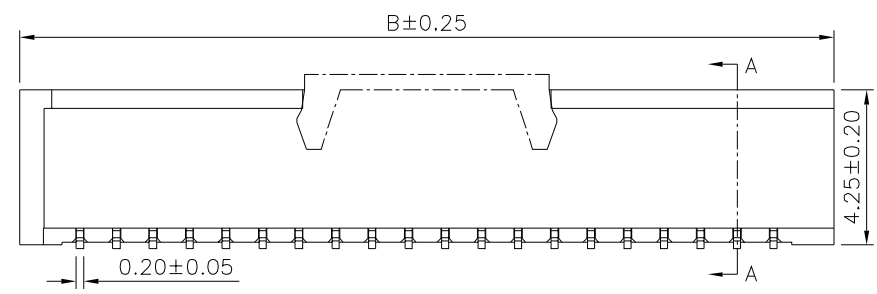

Pin	A	B	C
08	3.00	6.30	4.40
10	4.00	7.30	5.40
12	5.00	8.30	6.40
14	6.00	9.30	7.40
16	7.00	10.30	8.40
18	8.00	11.30	9.40
20	9.00	12.30	10.40
24	11.00	14.30	12.40
28	13.00	16.30	14.40
30	14.00	17.30	15.40
34	16.00	19.30	17.40
40	19.00	22.30	20.40
50	24.00	27.30	25.40
60	29.00	32.30	30.40

**4UCON** 元化興業股份有限公司  
 4UCON TECHNOLOGY INC.

DRAWING No.		APPROVED BY		UNLESS OTHERWISE SPECIFIED TOLERANCES ARE .X ±0.40 .XX ±0.25 .XXX ±0.15 ANG. ±3°
21263		MEI		
		CHECKED BY	HZF	
SCALE	NONE	DRAWING BY	CYP	
REV.	A0	UNIT	mm	

NO.	REV.	DESCRIPTION	CHK	DATE
△ A0		NEW RELEASE	HZF	09/07/2017
		REVISIONS		