

**SPECIFICATION**  
 Current Rating:7A Max.  
 Voltage Rating:250V AC Max.  
 Withstanding Voltage:1500V AC/Minute  
 Insulation Resistance:1000 Megaohms Min. DC 500V  
 Temperature Range:-40°C~+105°C  
 Insulator:PA66(UL94V-2)  
 RoHS Compliant

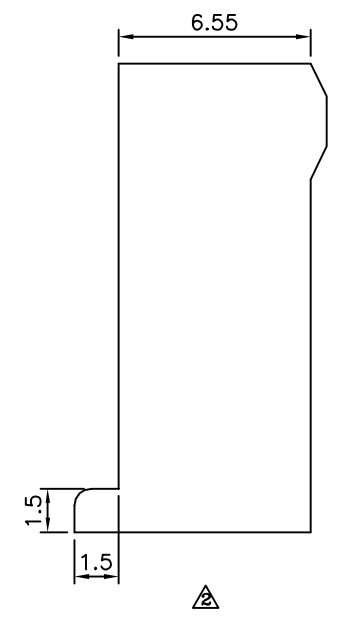
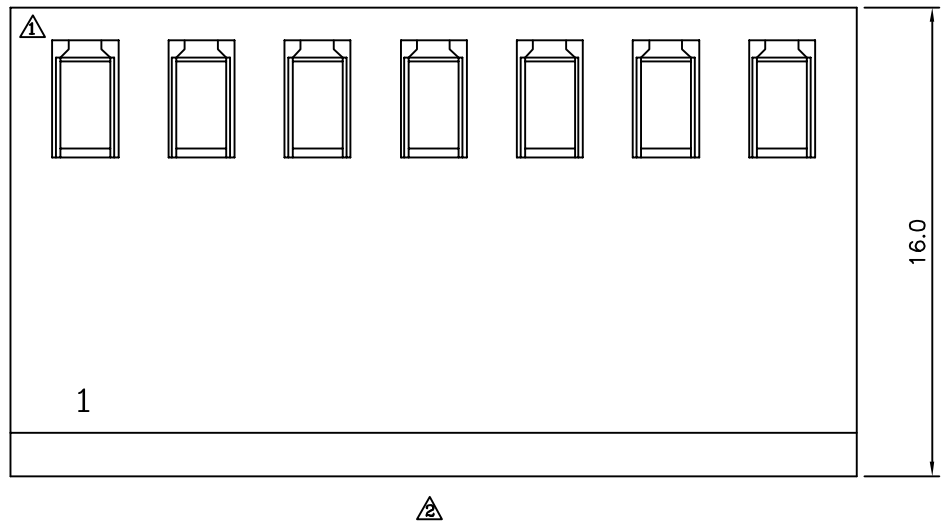
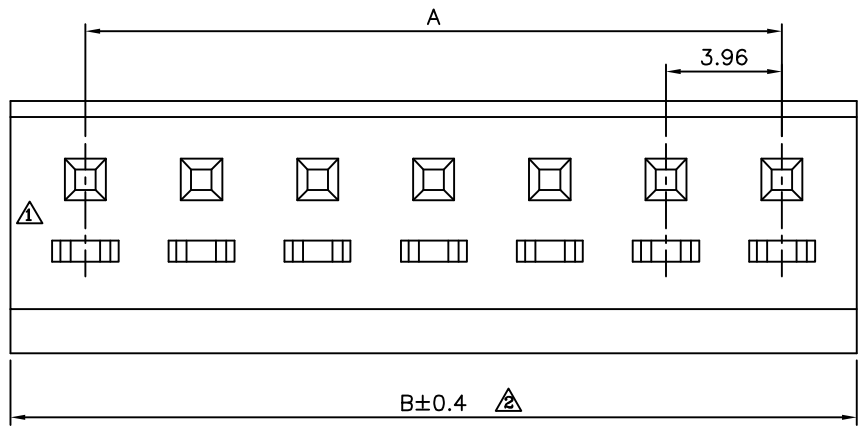

Pin	A	B
2	3.96	9.06
3	7.92	13.02
4	11.88	16.98
5	15.84	20.94
6	19.80	24.90
7	23.76	28.86
8	27.72	32.82
9	31.68	36.78
10	35.64	40.74
11	39.60	44.70
12	43.56	48.66
13	47.52	52.62
14	51.48	56.58
15	55.44	60.54

**4UCON** 元化興業股份有限公司  
 4UCON TECHNOLOGY INC.

DRAWING No.		APPROVED BY		UNLESS OTHERWISE SPECIFIED TOLERANCES ARE .X ±0.40 .XX ±0.25 .XXX ±0.08
10482		MEI		
		CHECKED BY	HZF	
		DRAWING BY	SONG	
SCALE	NONE	REV.	A2	UNIT mm

NO.	REV.	REVISIONS	CHK	DATE
		A2	HZF	10/24/2011
		A1	BECKY	04/19/2004
		A0		