

△ Recommended P.C.B. Layout

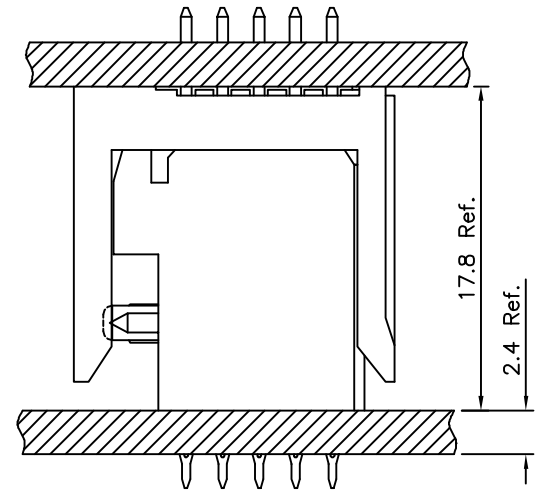

△ Board To Board Offset Application Example

△ SPECIFICATION

Current Rating:1 Amp
 Dielectric Withstanding Voltage:AC 1000V For 1 Minute
 Insulation Resistance:1000 Megaohms Min. At DC 500V
 Contact Resistance:30 Milliohms Max. At DC 100mA
 Operation Temperature:-55°C~+125°C
 Housing:LCP(UL94V-0)
 Contact:Phosphor Bronze
 Gold Plated 10u" On Contact Area,Tin Plated On Solder Tails,Over Nickel
 RoHS Compliant

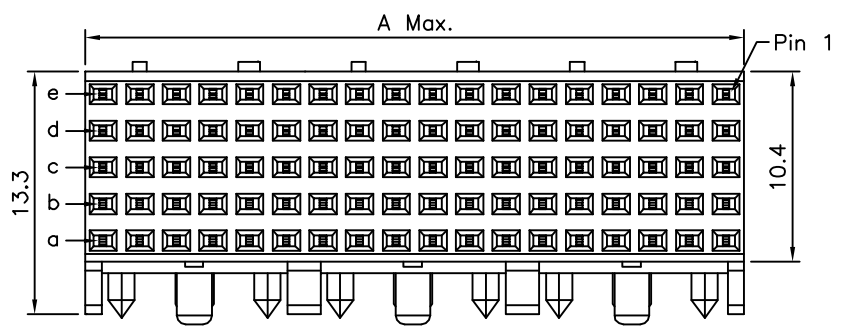

△

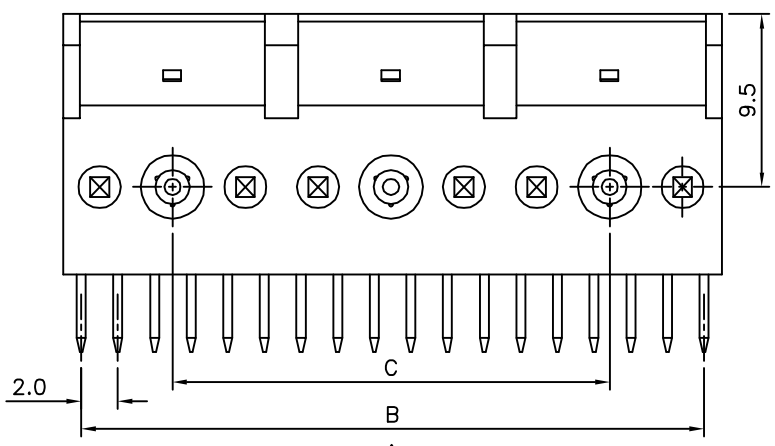

△

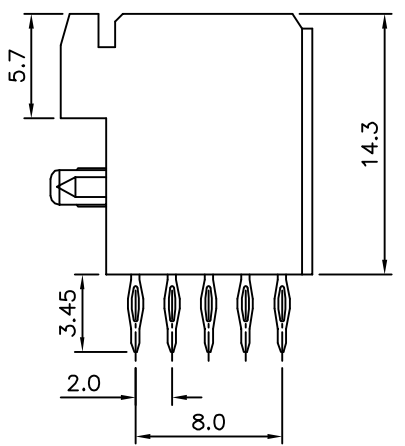

△

| Pin | A | B | C |
|-----|-------|------|------|
| 30 | 11.95 | 10.0 | 0 |
| 60 | 23.95 | 22.0 | 12.0 |
| 90 | 35.95 | 34.0 | 24.0 |
| 120 | 47.95 | 46.0 | 36.0 |
| 150 | 59.95 | 58.0 | 48.0 |
| 180 | 71.95 | 70.0 | 60.0 |
| 210 | 83.95 | 82.0 | 72.0 |
| 240 | 95.95 | 94.0 | 84.0 |

4UCON 元化興業股份有限公司
 4UCON TECHNOLOGY INC.

| | | | | |
|-------------|------|-------------|----|---|
| DRAWING No. | | APPROVED BY | | UNLESS OTHERWISE SPECIFIED TOLERANCES ARE |
| 18237 | | EMILY | | |
| | | CHECKED BY | | |
| | | HZF | | △ X. ±0.50 |
| | | DRAWING BY | | .X ±0.25 |
| | | SONG | | .XX ±0.15 |
| SCALE | NONE | REV. | A1 | UNIT mm |

| | | | |
|----------|-------------|-----|------------|
| NO. REV. | REVISIONS | CHK | DATE |
| △ A1 | Modify Data | HZF | 12/24/2013 |
| △ A0 | NEW RELEASE | | |