

Recommended P.C.B. Layout

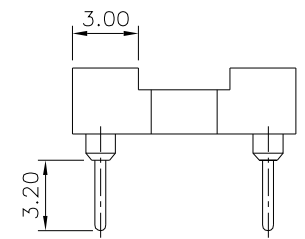
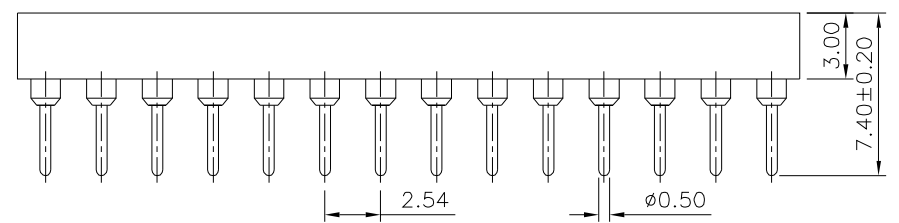
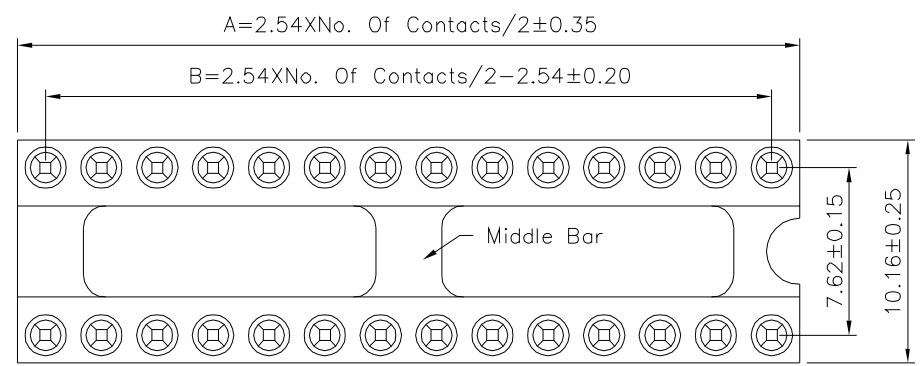

**SPECIFICATION**

Current Rating: 3 Amps/Contact Max.  
 Contact Resistance: 4 Milliohms/Contact Max.  
 Insulation Resistance: 1000 Megaohms Min. At 100V  
 Operating Voltage: 60V AC/DC  
 Average Insertion Force With Steel Pin Of  
 ø0.43mm: <250g  
 Average Withdrawal Force With Steel Pin Of  
 ø0.43mm: >50g Min.  
 Mechanical Life Cycle: 200 Min.  
 Operating Temperatures: Gold Plated: -55°C ~ +105°C  
 Tin Plated: -40°C ~ +105°C

Clip(Contact 4 Finger): Beryllium Copper, Gold Flash Over Nickel  
 Pin(Outer Sleeve): Brass, Tin Plated Over Nickel  
 Insulator(Housing): PBT(UL94V-0), Black  
 RoHS Compliant

Pin	A	B	Type
6	7.62	5.08	Without Bar
8	10.16	7.62	
10	12.70	10.16	
12	15.24	12.70	
14	17.78	15.24	Bar
16	20.32	17.78	
18	22.86	20.32	With Bar
20	25.40	22.86	
24	30.48	27.94	
28	35.56	33.02	

**4UCON** 元化興業股份有限公司  
 4UCON TECHNOLOGY INC.

DRAWING No.		APPROVED BY		UNLESS OTHERWISE SPECIFIED TOLERANCES ARE X. ±0.50 XX ±0.30 XXX ±0.20 .XXX ±0.10 ANG. ±5°
19136		MEI		
		CHECKED BY		
		HZF		
		DRAWING BY		UNIT mm
		CYP		
SCALE	NONE	REV.	BO	NO. REV.

△ BO	NEW RELEASE	HZF	06/06/2020
NO. REV.	REVISIONS	CHK	DATE