

SPECIFICATION
 Current Rating:1A AC/DC
 Voltage Rating:100V AC/DC
 Withstanding Voltage:500V AC/Minute
 Contact Resistance:20 Milliohms Max.
 Insulation Resistance:500 Megaohms Min.
 ⚠ Temperature Range: -40°C ~ +105°C
 Contact: Brass, Tin Plated Over Nickel
 Insulation: PA66(UL94V-0), Gray
 RoHS Compliant

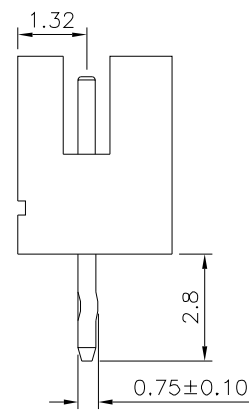
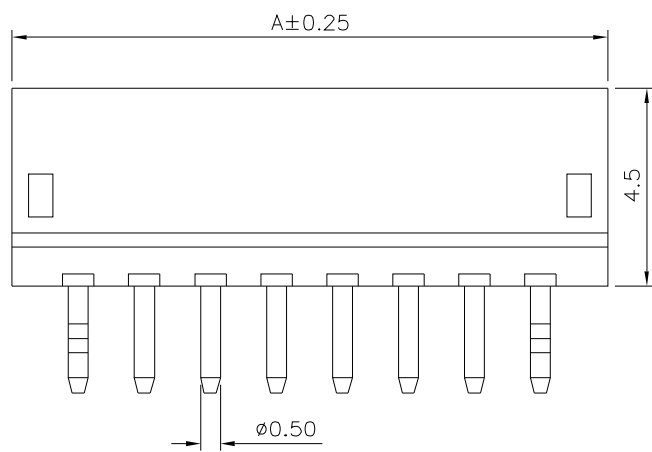
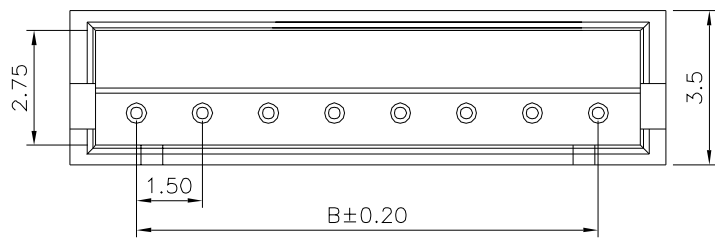

Pin	A	B
02	4.50	1.50
03	6.00	3.00
04	7.50	4.50
05	9.00	6.00
06	10.50	7.50
07	12.00	9.00
08	13.50	10.50
09	15.00	12.00
10	16.50	13.50
11	18.00	15.00
12	19.50	16.50
13	21.00	18.00

4UCON 元化興業股份有限公司
 4UCON TECHNOLOGY INC.

DRAWING No.		APPROVED BY		UNLESS OTHERWISE SPECIFIED TOLERANCES ARE .X ±0.30 .XX ±0.20 .XXX ±0.10 X.° ±2°
01313		MEI		
		CHECKED BY		
SCALE		NONE		UNIT mm
		REV.		
A1		HAO		

NO.	REV.	REVISIONS	CHK	DATE
⚠ A1		Modify Data	HZF	07/19/2021
⚠ A0		NEW RELEASE	HZF	07/04/2015