

Recommended PCB Layout
Thickness: 0.8~1.6mm

SPECIFICATION
 Current Rating: 2A
 Voltage Rating: 100V AC
 Contact Resistance: 20 Milliohms Max.
 Dielectric Withstanding Voltage: 800V AC/Minute
 Insulation Resistance: 1000 Megaohms Min.
 Temperature Range: -25°C ~ +85°C
 Insulator: PA66(UL94V-0), Nature
 Contact: Brass, Tin Plated
 RoHS Compliant

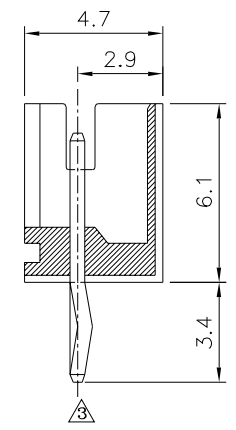
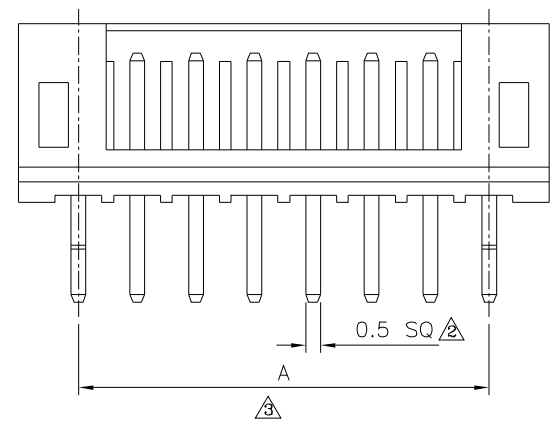
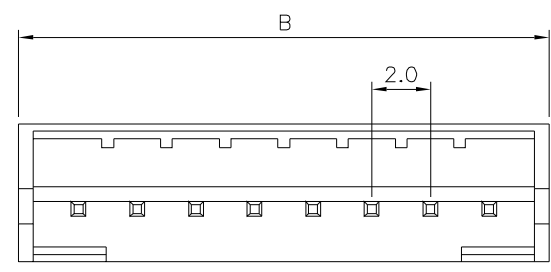

Pin	A	B
2	2.0	6.1
3	4.0	8.1
4	6.0	10.1
5	8.0	12.1
6	10.0	14.1
7	12.0	16.1
8	14.0	18.1
9	16.0	20.1
10	18.0	22.1
11	20.0	24.1
12	22.0	26.1
13	24.0	28.1
14	26.0	30.1
15	28.0	32.1
16	30.0	34.1

4UCON 元化興業股份有限公司
4UCON TECHNOLOGY INC.

DRAWING No.		APPROVED BY		UNLESS OTHERWISE SPECIFIED TOLERANCES ARE .X ±0.3 .XX ±0.2 ANG.
01536		EMILY		
		CHECKED BY HZF		
DRAWING BY		CYP		UNIT
SCALE	NONE	REV.	A3	mm

NO.	REV.	REVISIONS	CHK	DATE
3	A3	Modify Data	HZF	02/05/2015
2	A2	Modify Data	HZF	03/23/2010
1	A1	Modify Data	BECKY	2005/02/17
0	A0	NEW RELEASE		