

**△ SPECIFICATION**  
 Current Rating: 3A AC/DC  
 Voltage Rating: 250V AC/DC  
 Temperature Range: -25°C~+85°C  
 Contact Resistance: 10 Milliohms Max.  
 Insulation Resistance: 1000 Megaohms Min.  
 Withstanding Voltage: 1000V AC/Minute  
 Insulator: PA66(UL94V-0), Nature  
 RoHS Compliant

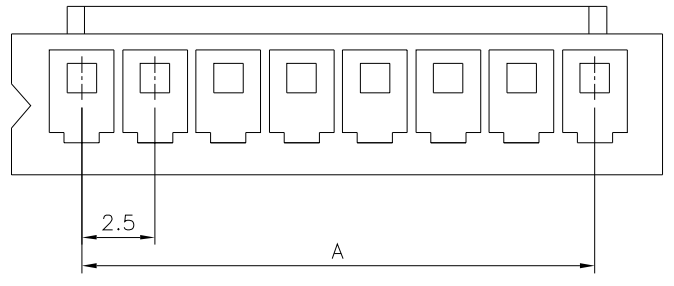

△

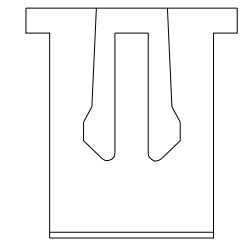
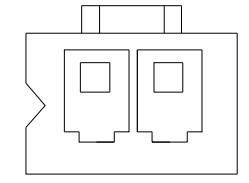

△ 2 Pin

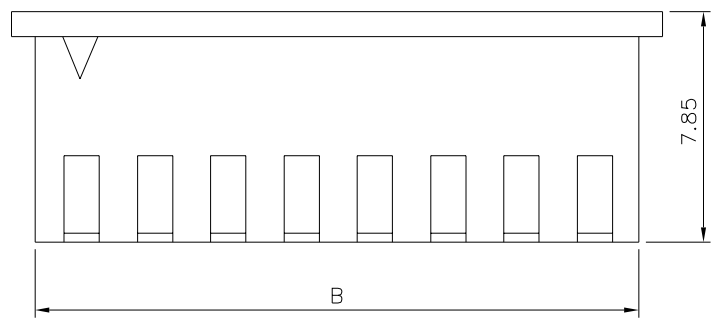

△

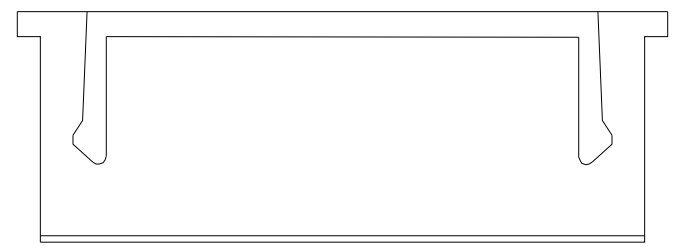
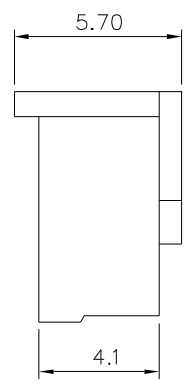

△ 3~20 Pin

Pin	A	B
02	2.50	5.70
03	5.00	8.20
04	7.50	10.70
05	10.00	13.20
06	12.50	15.70
07	15.00	18.20
08	17.50	20.70
09	20.00	23.20
10	22.50	25.70
11	25.00	28.20
12	27.50	30.70
13	30.00	33.20
14	32.50	35.70
15	35.00	38.20
16	37.50	40.70
20	47.50	50.70

**4UCON** 元化興業股份有限公司  
 4UCON TECHNOLOGY INC.

DRAWING No. △		APPROVED BY		UNLESS OTHERWISE SPECIFIED TOLERANCES ARE .X ±0.30 △ .XX ±0.20
01591		MEI		
		CHECKED BY HZF		
		DRAWING BY YBL		
SCALE	NONE	REV.	A3	UNIT mm

NO.	REV.	REVISIONS	CHK	DATE
△	A3	Modify Data	HZF	12/04/2013
△	A2	Modify Data	HZF	03/24/2010
△	A1	Modify Data	BECKY	2004/11/19
△	A0	NEW RELEASE		