

△ SPECIFICATION
 Electrical Rating:UL:250V 1A,AC/DC
 CSA:250V 1A,AC/DC
 Insulator:PA66(UL94V-2),White
 Contact:Brass,Tin Plated Over Nickel
 RoHS Compliant

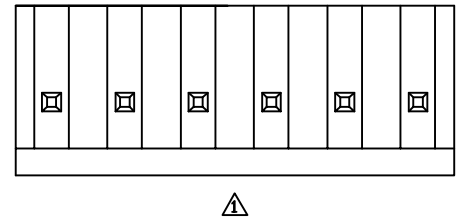
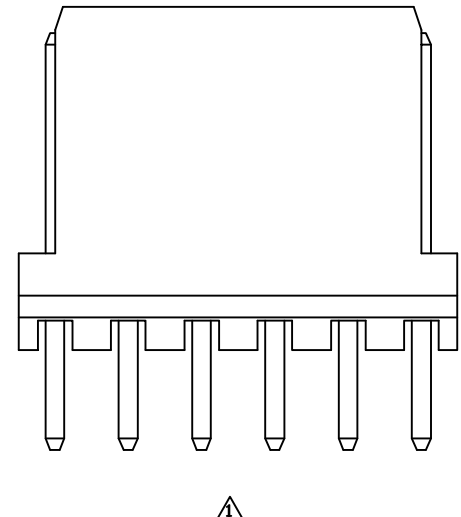
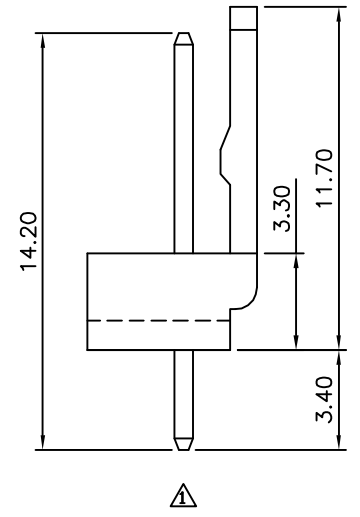
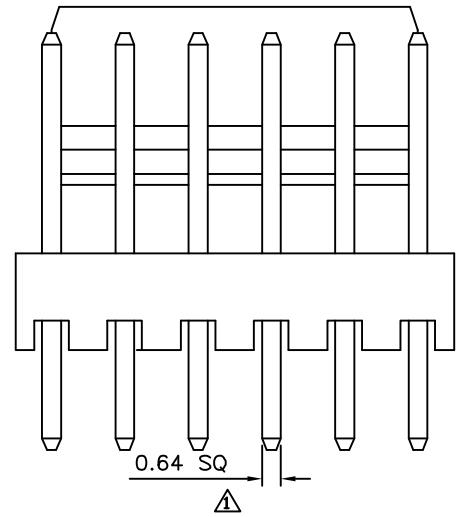

Pin	A	B	Pin	A	B
2	2.50	5.00	12	27.50	30.00
3	5.00	7.50	13	30.00	32.50
4	7.50	10.00	14	32.50	35.00
5	10.00	12.50	15	35.00	37.50
6	12.50	15.00	16	37.50	40.00
7	15.00	17.50	17	40.00	42.50
8	17.50	20.00	18	42.50	45.00
9	20.00	22.50	19	45.00	47.50
10	22.50	25.00	20	47.50	50.00
11	25.00	27.50			

4UCON 元化興業股份有限公司
 4UCON TECHNOLOGY INC.

DRAWING No.		APPROVED BY		UNLESS OTHERWISE SPECIFIED TOLERANCES ARE .X ±0.30 .XX ±0.20 .XXX ±0.10 ANG. ±2°
01891		EMILY		
		CHECKED BY		
		HZF		
		DRAWING BY		UNIT mm
		GAO		
SCALE	NONE	REV.	A2	

NO.	REV.	REVISIONS	CHK	DATE
△A2		Add P/N Code	HZF	02/20/2013
△A1		Modify Data	HZF	03/14/2011
△A0		NEW RELEASE	HZF	01/13/2010