

**SPECIFICATION**

Current Rating:3A AC/DC  
 Voltage Rating:250V AC/DC  
 Temperature Range:-25°C~+85°C  
 Insulation Resistance:1000 Megaohms Min.  
 Withstand Voltage:800V AC/Minute  
 Material:Noryl(UL94V-1),Black  
 RoHS Compliant

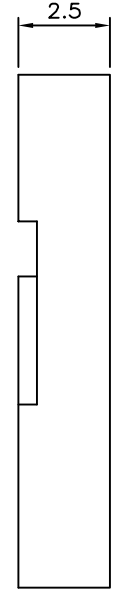
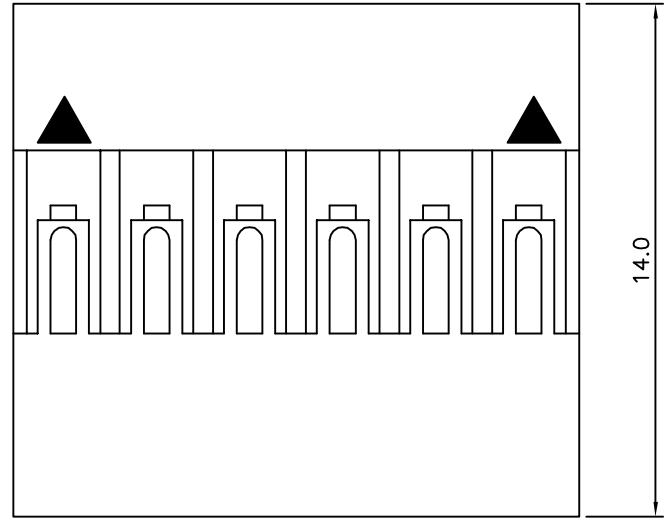
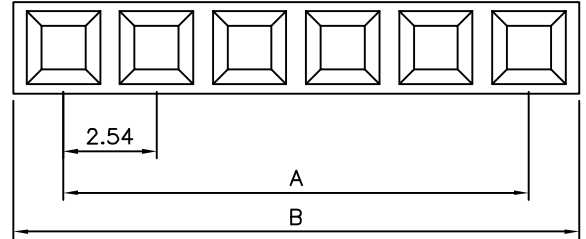

| Circuits | Dim.A | Dim.B | Circuits | Dim.A | Dim.B  |
|----------|-------|-------|----------|-------|--------|
| 1        | —     | 2.65  | 21       | 50.80 | 53.54  |
| 2        | 2.54  | 5.28  | 22       | 53.34 | 56.08  |
| 3        | 5.08  | 7.82  | 23       | 55.88 | 58.62  |
| 4        | 7.62  | 10.36 | 24       | 58.42 | 61.16  |
| 5        | 10.16 | 12.90 | 25       | 60.96 | 63.70  |
| 6        | 12.70 | 15.44 | 26       | 63.50 | 66.24  |
| 7        | 15.24 | 17.98 | 26       | 66.04 | 68.78  |
| 8        | 17.78 | 20.52 | 28       | 68.58 | 71.32  |
| 9        | 20.32 | 23.06 | 28       | 71.12 | 73.86  |
| 10       | 22.86 | 25.60 | 30       | 73.66 | 76.40  |
| 11       | 25.40 | 28.14 | 31       | 76.20 | 78.94  |
| 12       | 27.94 | 30.68 | 32       | 78.74 | 81.48  |
| 13       | 30.48 | 33.22 | 33       | 81.28 | 84.02  |
| 14       | 33.02 | 35.76 | 34       | 83.82 | 86.56  |
| 15       | 35.56 | 38.30 | 35       | 86.36 | 89.10  |
| 16       | 38.10 | 40.84 | 36       | 88.90 | 91.64  |
| 17       | 40.64 | 43.38 | 37       | 91.44 | 94.18  |
| 18       | 43.18 | 45.92 | 38       | 93.98 | 96.72  |
| 19       | 45.72 | 48.46 | 39       | 96.52 | 99.26  |
| 20       | 48.26 | 51.00 | 40       | 99.06 | 101.80 |

**4UCON** 元化興業股份有限公司  
 4UCON TECHNOLOGY INC.

DRAWING No. 02054

APPROVED BY EMILY  
 CHECKED BY HZF  
 DRAWING BY HAO

UNLESS OTHERWISE SPECIFIED TOLERANCES ARE  
 .X ±0.38  
 .XX ±0.25  
 ANG.

SCALE NONE REV. A3

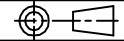

| NO. | REV. | REVISIONS   | CHK   | DATE       |
|-----|------|-------------|-------|------------|
| 3   | A3   | Modify Data | HZF   | 08/27/2014 |
| 2   | A2   | Modify Data | HZF   | 03/15/2010 |
| 1   | A1   | Modify Data | BECKY | 2005/04/19 |
| 0   | A    | NEW RELEASE | RAN   |            |