

Recommended P.C.B. Layout

SPECIFICATION
 ⚠ Current Rating: 3A AC/DC
 Voltage Rating: 250V AC Max.
 Dielectric Withstanding Voltage: 800V AC/Minute
 Contact Resistance: 10 Milliohms Max.
 Insulation Resistance: 1000 Megaohms Min.
 Operating Temperature: -25°C~+85°C
 Terminal: Brass, Tin Plated Over Copper
 ⚠ Insulator: PA66(UL94V-0), White
 RoHS Compliant

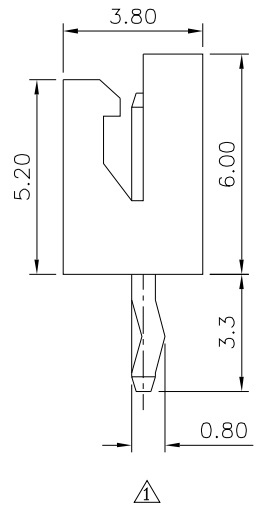
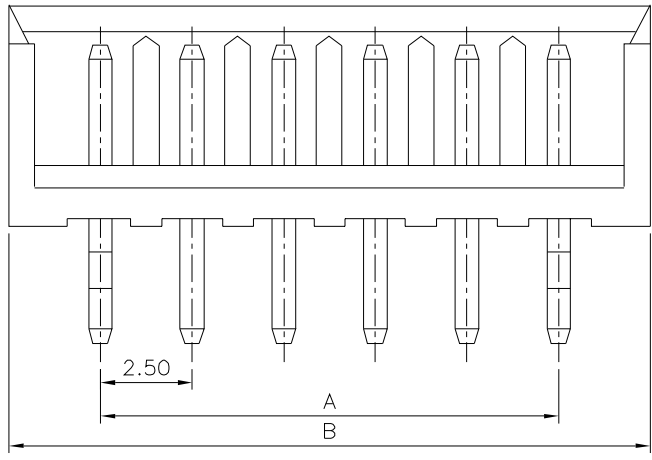
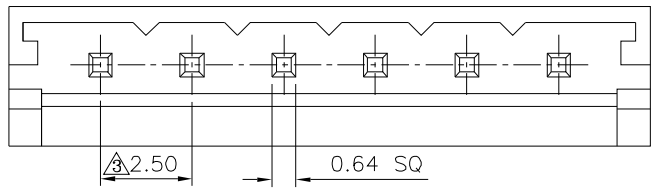

Pin	A	B
02	2.50	7.50
03	5.00	10.00
04	7.50	12.50
05	10.00	15.00
06	12.50	17.50
07	15.00	20.00
08	17.50	22.50
09	20.00	25.00
10	22.50	27.50
11	25.00	30.00
12	27.50	32.50

4UCON 元化興業股份有限公司
 4UCON TECHNOLOGY INC.

DRAWING No.		APPROVED BY		UNLESS OTHERWISE SPECIFIED TOLERANCES ARE .X ±0.3 .XX ±0.2
02560		MEI		
		CHECKED BY HZF		
DRAWING BY		HAO		
SCALE	NONE	REV.	A3	UNIT mm

NO.	REV.	REVISIONS	CHK	DATE
⚠	A3	Modify Data	HZF	08/12/2015
⚠	A2	Modify Data	HZF	05/11/2012
⚠	A1	Modify Data	HZF	07/31/2010
⚠	A0	NEW RELEASE	HZF	06/05/2007