

△ Recommended P.C.B. Layout

△ SPECIFICATION
 Current Rating:3A AC/DC
 Voltage Rating:250V AC Max.
 Contact Resistance:10 Milliohms Max.
 Insulation Resistance:1000 Megohms Min.
 Temperature Range:-25°C~+85°C
 Dielectric Withstanding:800V AC/Minute
 Insulator:PA66(UL94V-0)
 Contact:Brass,Tin Plated
 RoHS Compliant

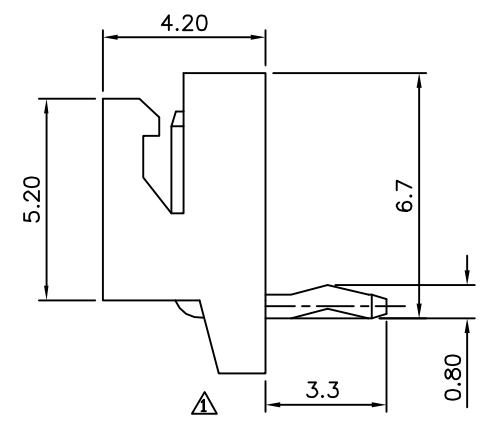
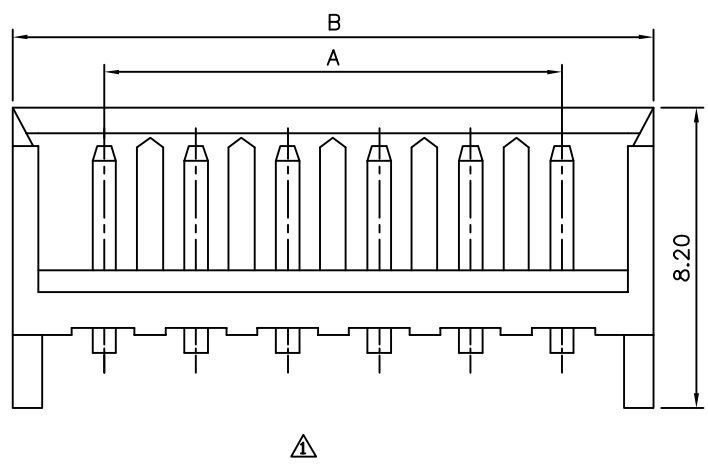
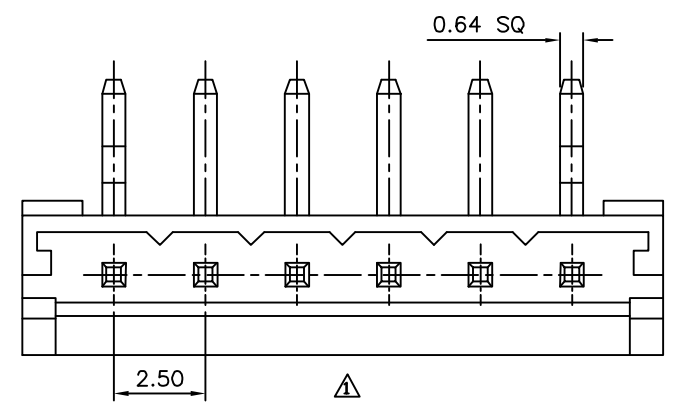

Pin	A	B
2	2.50	7.50
3	5.00	10.00
4	7.50	12.50
5	10.00	15.00
6	12.50	17.50
7	15.00	20.00
8	17.50	22.50
9	20.00	25.00
10	22.50	27.50
11	25.00	30.00
12	27.50	32.50

4UCON 元化興業股份有限公司
 4UCON TECHNOLOGY INC.

DRAWING No.		APPROVED BY		UNLESS OTHERWISE SPECIFIED TOLERANCES ARE .X ±0.3 .XX ±0.2 △ UNIT mm
02575		EMILY		
		CHECKED BY		
		HZF		
		DRAWING BY		
		WSS		
SCALE	NONE	REV.	A2	

NO.	REV.	REVISIONS	CHK	DATE
△ A2		Delete 13~15 Pin	HZF	05/11/2012
△ A1		Modify Data	HZF	03/01/2011
△ A0		NEW RELEASE	RAN	