

△ Recommended P.C.B. Layout

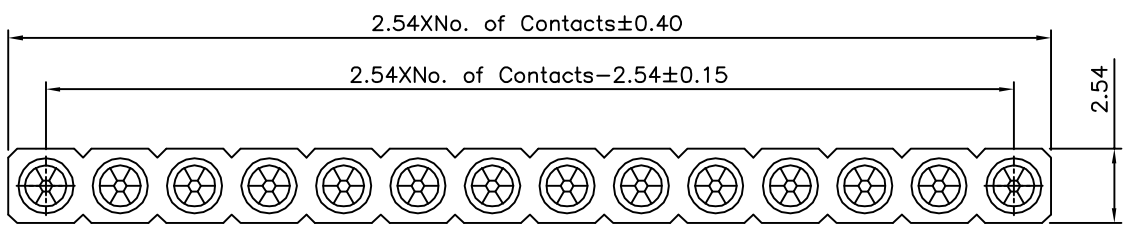

△

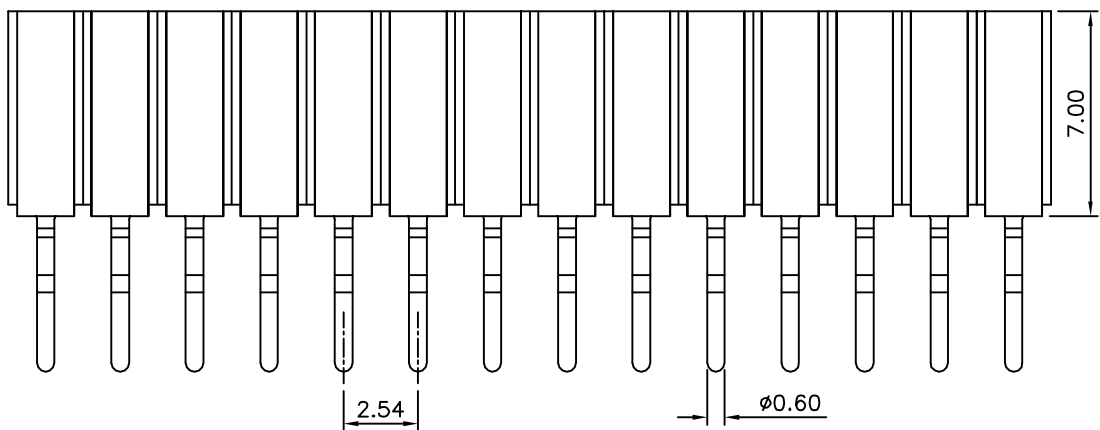

△

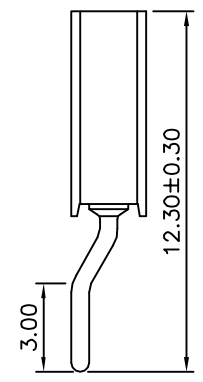

△

△ SPECIFICATION

Current Rating: 3 Amps/Contact Max.  
 Operating Voltage: 60V AC/DC  
 Contact Resistance: 4 Milliohms Max./Contact  
 Insulation Resistance: 1000 Megaohms Min. At 100V  
 Operating Temperature: Gold Plated: -55°C ~ +105°C  
 Tin Plated: -40°C ~ +105°C  
 Soldering Temperature: +260°C, 10s Max.  
 Average Insertion Force With Steel Pin Of  $\phi 0.66\text{mm}$ : <140g  
 Average Withdrawal Force With Steel Pin  
 Of  $\phi 0.66\text{mm}$ : >25g Min.  
 Mechanical Life Cycle: 200 Min.  
 Pin (Outer Sleeve): Brass, Tin Plated Over Nickel  
 Clip (Contact 6 Finger): Beryllium Copper,  
 Gold Flash Over Nickel  
 Insulator (Housing): PPS (UL94V-0), Black  
 RoHS Compliant

**4UCON** 元化興業股份有限公司  
 4UCON TECHNOLOGY INC.

|             |      |             |    |   |
|-------------|------|-------------|----|---|
| DRAWING No. |      | APPROVED BY |    | UNLESS OTHERWISE SPECIFIED TOLERANCES ARE<br>X. ±0.50<br>△ X ±0.30<br>XX ±0.20<br>XXX ±0.10<br>ANG. ±5° |
| 02648       |      | EMILY       |    |   |
|             |      | CHECKED BY  |    |   |
|             |      | HZF         |    |   |
|             |      | DRAWING BY  |    | UNIT mm   |
|             |      | YBL         |    |   |
| SCALE       | NONE | REV.        | A1 |   |

|      |      |             |     |            |
|------|------|-------------|-----|------------|
| NO.  | REV. | REVISIONS   | CHK | DATE       |
| △ A1 |      | Modify Data | HZF | 01/21/2014 |
| △ A0 |      | NEW RELEASE | HZF | 11/23/2006 |