

Recommended P.C.B. Layout(26,44,62 Pin)

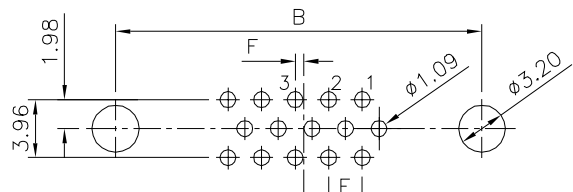

Recommended P.C.B. Layout(15 Pin)

△△ SPECIFICATION
 Current Rating:1 Amps
 Withstand Voltage:500V For 1 Minute
 Contact Resistance:30 Milliohms Max.
 Insulation Resistance:1000 Megohms Min.
 At 500V DC
 Operation Temperature:-55°C~+105°C
 Insulator:PBT+30%G.F.(UL94V-0),White
 Contact:Brass,Gold Flash Over Nickel
 Shell:Steel,Front:Nickel Plated,Rear:Tin Plated
 RoHS Compliant

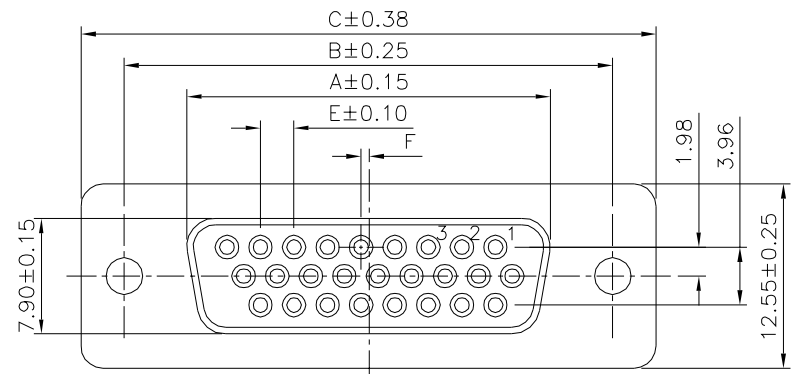

△ 26,44,62 Pin

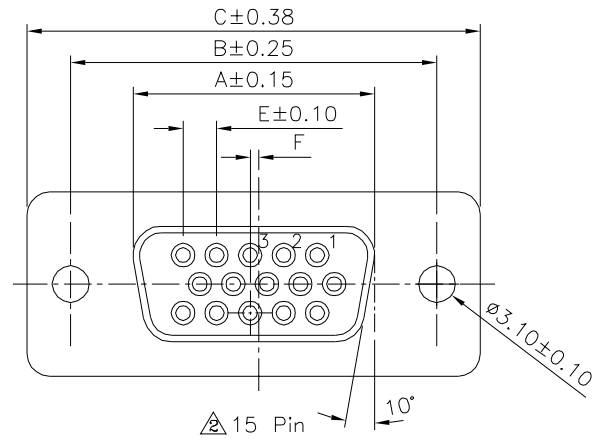

△ 15 Pin

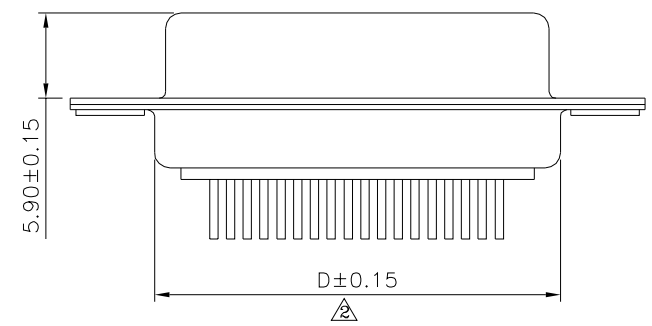

△

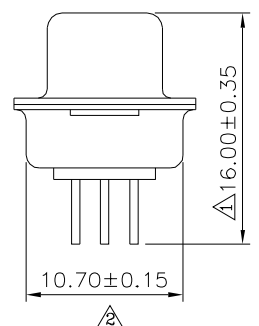

△

Item No.	Position	A	B	C	D	E	F
02679	15	16.33	24.99	30.81	19.20	2.29	0.25
02692	26	24.80	33.32	39.20	27.70	2.29	0.50
02693	44	38.38	47.04	53.04	41.10	2.29	0.50
02694	62	54.84	63.50	69.40	57.30	2.41	0.60

4UCON 元化興業股份有限公司
 4UCON TECHNOLOGY INC.

DRAWING No.		APPROVED BY		UNLESS OTHERWISE SPECIFIED TOLERANCES ARE .X ±0.38 .X* ±3* .XX ±0.25 .XX* ±1* .XXX ±0.10 .XXX* ±0.5* UNIT mm
02694		MEI		
		CHECKED BY	HZF	
SCALE	NONE	DRAWING BY	CYP	
		REV.	A2	UNIT mm

NO.	REV.	REVISIONS	CHK	DATE
△	A2	Modify Data	HZF	10/30/2020
△	A1	Modify Data	HZF	01/21/2010
△	A0	NEW RELEASE	HZF	06/17/2008