

Recommended P.C.B. Layout

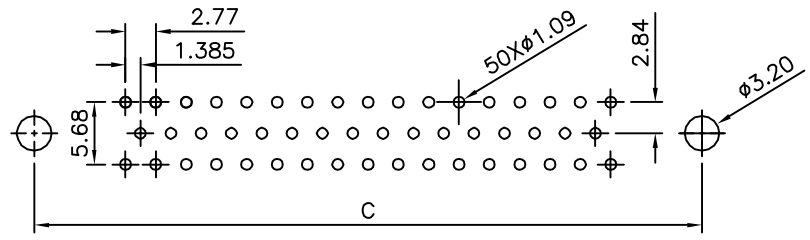

Recommended P.C.B. Layout

**△△ SPECIFICATION**  
 Current Rating:5 Amps  
 Withstanding Voltage:1000V(One Minute)  
 Insulation Resistance:1000 Megaohms Min.  
 At 500V DC  
 Contact Resistance:20 Milliohms Max.  
 Operation Temperature:-50°C~+105°C  
 Insulator:PBT+30%G.F.(UL94V-0),White  
 Contact:Brass,Gold Flash Over Nickel  
 Shell:SPCC,Front:Nickel Plated,Rear:Tin Plated  
 Nut:Copper Alloy,Nickel Plated  
 RoHS Compliant

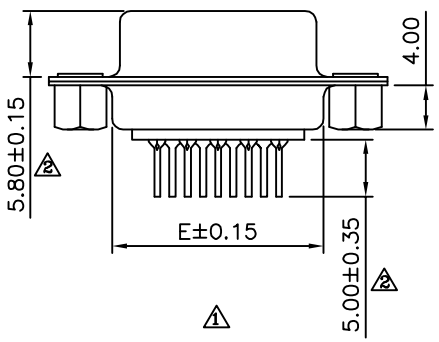
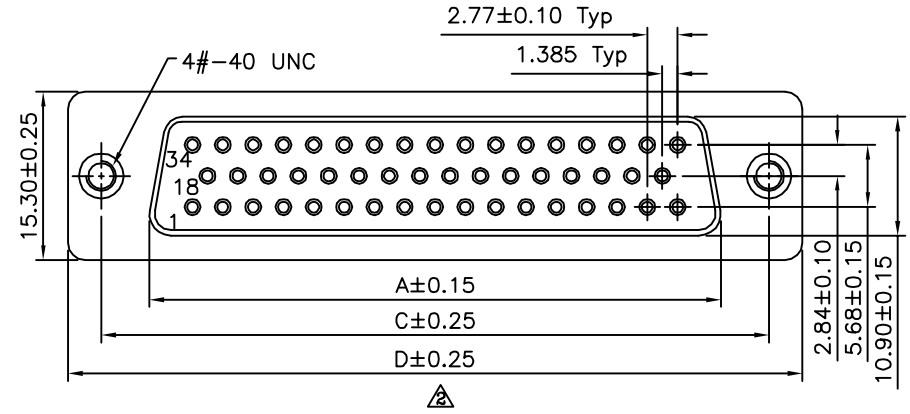
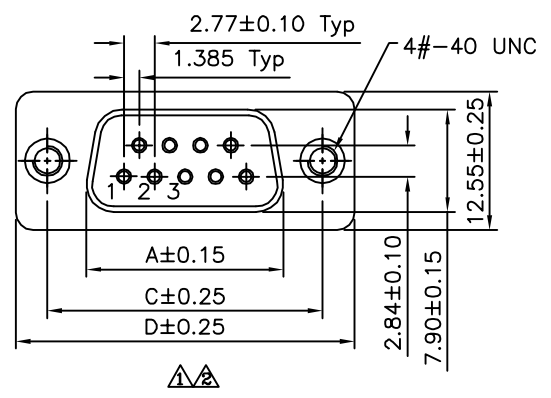

09,15,25,37 Pin

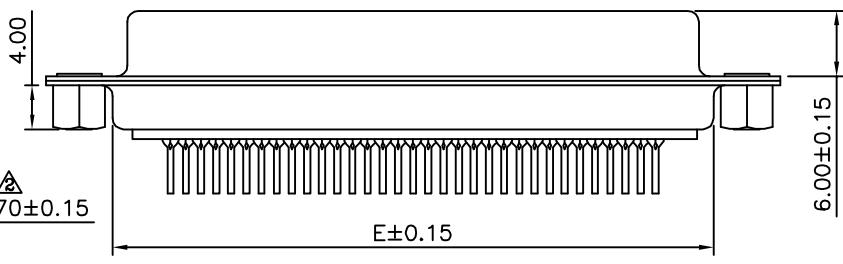
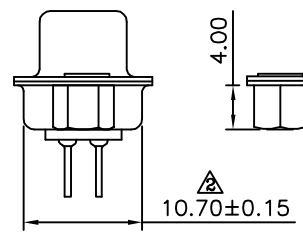

50 Pin

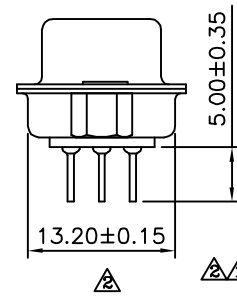

Pin	A	C	D	E
09	16.33	24.99	30.81	19.20
15	24.80	33.32	39.20	27.70
25	38.38	47.04	53.04	41.10
37	54.84	63.50	69.40	57.30
50	52.20	61.00	67.00	55.10

**4UCON** 元化興業股份有限公司  
 4UCON TECHNOLOGY INC.

DRAWING No. 02942  
 APPROVED BY MEI  
 CHECKED BY HZF  
 DRAWING BY SONG  
 SCALE NONE REV. A2

UNLESS OTHERWISE SPECIFIED TOLERANCES ARE  
 .X ±0.38 .X\* ±3\*  
 .XX ±0.25 .XX\* ±1\*  
 .XXX ±0.05 .XXX\* ±0.5\*  
 UNIT mm

NO.	REV.	REVISIONS	CHK	DATE
△A2		Modify Data	HZF	11/30/2011
△A1		Modify Data	HZF	04/26/2011
△A0		NEW RELEASE	HZF	07/28/2009