

SPECIFICATIONS:

Contact Current Rating: 1 Amp
 Dielectric Withstanding Voltage: AC 500V R.M.S.
 Insulation Resistance : 500Megohms Min. At DC 500V
 Contact Resistance: 30Milliohms. Max.
 Operating Temperature: -55°C ~ +105°C
 Contact: Brass, Tin Plated
 Insulator: P.B.T. UL94V-0 Rated
 Shell: Cold Rolled Steel, Tin Plated

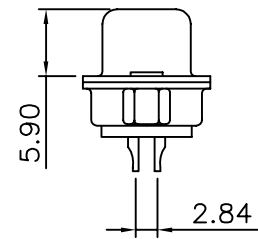
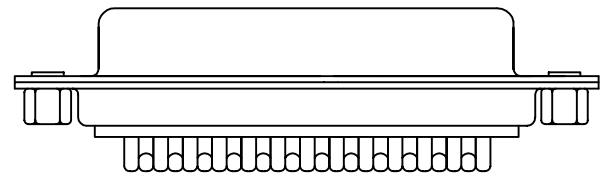
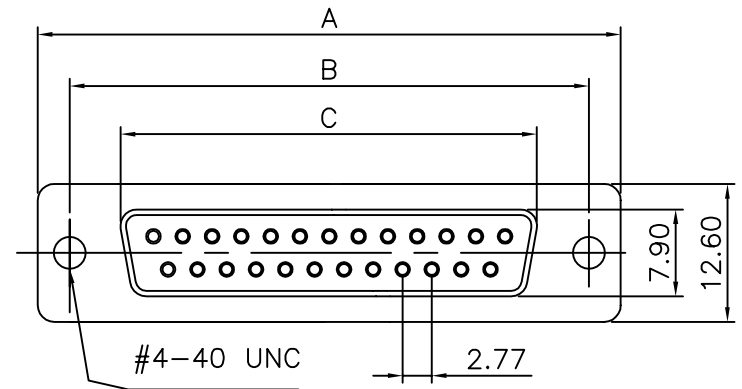

| Positions | A±0.25 | B±0.25 | C±0.25 |
|-----------|--------|--------|--------|
| 09 | 30.80 | 25.00 | 16.30 |
| 15 | 39.20 | 33.32 | 24.70 |
| 19 | 44.90 | 38.86 | 30.00 |
| 23 | 50.30 | 44.30 | 35.50 |
| 25 | 53.05 | 47.04 | 38.40 |
| 37 | 69.40 | 63.50 | 54.80 |

4UCON 元化興業股份有限公司
 4UCON TECHNOLOGY INC.

DRAWING No.
 03303

APPROVED BY MEI
 CHECKED BY RAN
 DRAWING BY HZF

UNLESS OTHERWISE SPECIFIED TOLERANCES ARE
 .X ±0.38
 .XX ±0.25
 ANG.

SCALE NONE

REV. A

UNIT mm

AREA REVISIONS CHK DATE