

Recommended PCB Layout

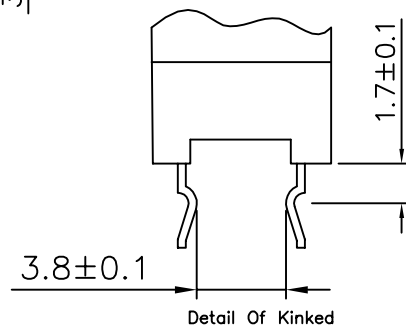
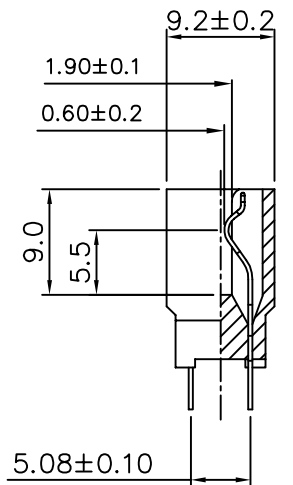

Detail Of Kinked

SPECIFICATIONS

Current Rating:3 AMP
 Dielectric Withstanding Voltage:1,000V AC RMS
 Insulation Resistance:5,000Megohms Min.At 500V DC
 Contact Resistance:20Milliohms Max.
 Insertion Force:340 Grams Max.Per Contact Pair
 Withdrawal Force:28 Grams Min.Per Contact Pair
 Temperature Range:-55°C To +105°C
 Insulator:Glass-Reinforced Thermoplastic (PBT),UL 94V-0 Rated
 Contact:Copper Alloy
 Gold Plated 15u" Over Nickel On Mating Area
 Tin/Lead Over Nickel On Solder Area

Positions	DIM A	DIM B	DIM C	DIM D	Kinked	Positions	DIM A	DIM B	DIM C	DIM D	Kinked
2x3=6	14.22	10.16	5.08	11.68	---	2x32=64	87.88	83.82	78.74	85.34	WXYZ
2x4=8	16.76	12.70	7.62	14.22	---	2x33=66	90.42	86.36	81.28	87.88	WXYZ
2x5=10	19.30	15.24	10.16	16.76	---	2x34=68	92.96	88.90	83.82	90.42	WXYZ
2x6=12	21.84	17.78	12.70	19.30	---	2x35=70	95.50	91.44	86.36	92.96	WXYZ
2x7=14	24.38	20.32	15.24	21.84	---	2x36=72	98.04	93.98	88.90	95.50	WXYZ
2x8=16	26.92	22.86	17.78	24.38	---	2x37=74	100.58	96.52	91.44	98.04	WXYZ
2x9=18	29.46	25.40	20.32	26.92	---	2x38=76	103.12	99.06	93.98	100.58	WXYZ
2x10=20	32.00	27.94	22.86	29.46	XY	2x39=78	105.66	101.60	96.52	103.12	WXYZ
2x11=22	34.54	30.48	25.40	32.00	XY	2x40=80	108.20	104.14	99.06	105.66	WXYZ
2x12=24	37.08	33.02	27.94	34.54	XY	2x41=82	110.74	106.68	101.60	108.20	WXYZ
2x14=28	42.16	38.10	33.02	39.62	XY	2x42=84	113.28	109.22	104.14	110.74	WXYZ
2x15=30	44.70	40.64	35.56	42.16	XY	2x43=86	115.82	111.76	106.68	113.28	WXYZ
2x16=32	47.24	43.18	38.10	44.70	XY	2x44=88	118.36	114.30	109.22	115.82	WXYZ
2x17=34	49.78	45.72	40.64	47.24	XY	2x45=90	120.90	116.84	111.76	118.36	WXYZ
2x19=38	54.86	50.80	45.72	52.32	XY	2x46=92	123.44	119.38	114.30	120.90	WXYZ
2x20=40	57.40	53.34	48.26	54.86	XY	2x47=94	125.98	121.92	116.84	123.44	WXYZ
2x21=42	59.94	55.88	50.80	57.40	XY	2x48=96	128.52	124.46	119.38	125.98	WXYZ
2x22=44	62.48	58.42	53.34	59.94	XY	2x50=100	133.60	129.54	124.46	131.06	WXYZ
2x23=46	65.02	60.96	55.88	62.48	XY	2x51=102	136.14	132.08	127.00	133.60	WXYZ
2x24=48	67.56	63.50	58.42	65.02	XY	2x53=106	141.22	137.16	132.08	138.68	WXYZ
2x25=50	70.10	66.04	60.96	67.56	XY	2x54=108	143.76	139.70	134.62	141.22	WXYZ
2x26=52	72.64	68.58	63.50	70.10	XY	2x55=110	146.30	142.24	137.16	143.76	WXYZ
2x27=54	75.18	71.12	66.04	72.64	XY	2x56=112	148.84	144.78	139.70	146.30	WXYZ
2x28=56	77.72	73.66	68.58	75.18	XY	2x57=114	151.38	147.32	142.24	148.84	WXYZ
2x29=58	80.26	76.20	71.12	77.72	XY	2x58=116	153.92	149.86	144.78	151.38	WXYZ
						2x59=118	156.46	152.40	147.32	153.92	WXYZ

4UCON 元化興業股份有限公司
 4UCON TECHNOLOGY INC.

DRAWING No.
 04585

APPROVED BY MEI
 CHECKED BY RAN
 DRAWING BY HZF

UNLESS OTHERWISE SPECIFIED TOLERANCES ARE
 .X ±0.38
 .XX ±0.25
 ANG.

SCALE NONE REV. A UNIT mm

AREA REVISIONS CHK DATE