

SPECIFICATION

Current Rating: 3 Amperes
 Voltage Rating: 800V AC 1 Minute
 Contact Resistance: 20 Milliohms Max.
 Insulation Resistance: 5000 Megohms Min.
 Operating Temperature: -55°C To 105°C
 Insertion Force: 412 Grams Max. Per Pair
 Withdrawal Force: 32 Grams Min. Per Pair
 Insulator: Glass-Filled P.B.T. Is 94V-0 Rated
 Contact: Phosphor Bronze
 Selective Gold Plating Over Nickel

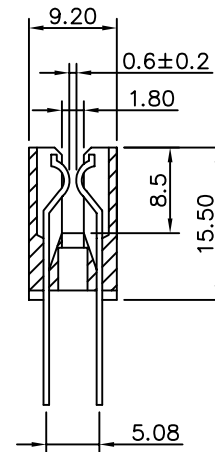
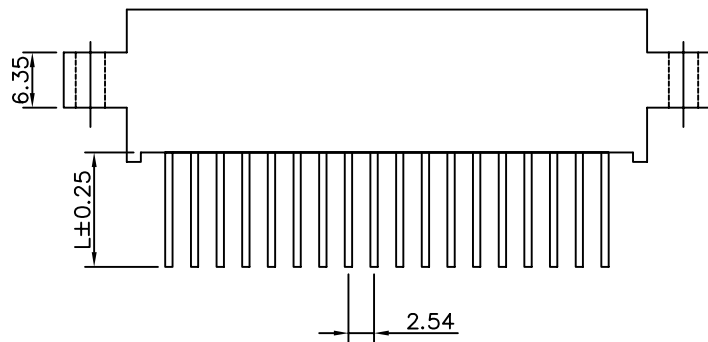
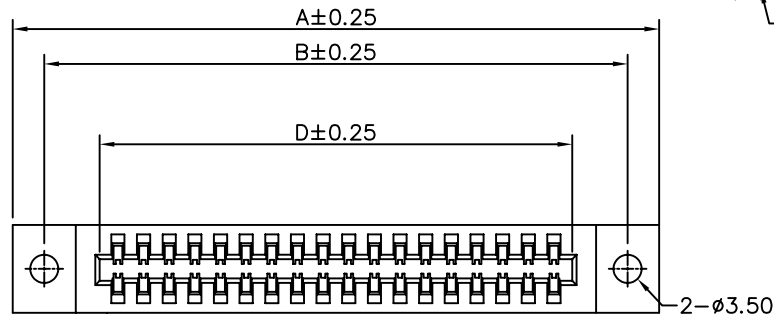
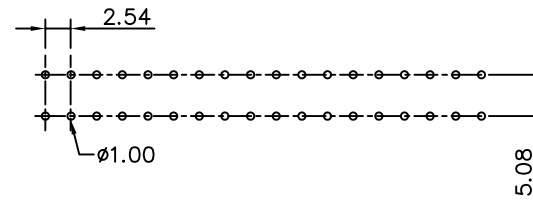

L	4.70	6.10	14.10	21.80
---	------	------	-------	-------

Positions	A	B	C	D	E
12/24	51.69	45.09	37.38	33.22	27.94
22/44	77.09	70.49	62.78	58.62	53.34
24/48	82.17	75.57	67.86	63.70	58.42
25/50	84.71	78.11	70.40	66.24	50.96
28/56	92.33	85.73	78.02	73.86	68.58
30/60	97.41	90.81	83.10	78.94	73.66
35/70	110.11	103.51	95.80	78.94	73.66
36/72	112.65	106.05	98.34	94.18	88.90
43/86	130.43	123.83	116.12	111.96	106.68
44/88	132.97	126.37	118.66	114.50	109.22
50/100	148.21	141.61	133.90	129.74	124.46

4UCON 元化興業股份有限公司
 4UCON TECHNOLOGY INC.

DRAWING No.
 04608

APPROVED BY MEI
 CHECKED BY LHC
 DRAWING BY HZF

UNLESS OTHERWISE SPECIFIED
 TOLERANCES ARE
 .X ±0.38
 .XX ±0.25
 ANG.

SCALE NONE

REV. A

UNIT mm

NO. REV.

REVISIONS

CHK

DATE