

Recommended P.C.B. Layout

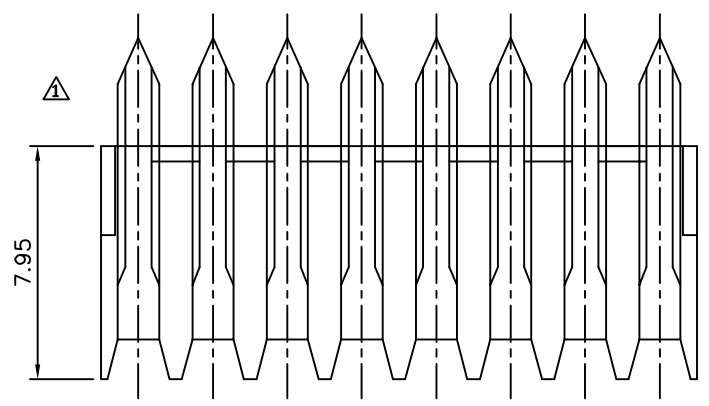
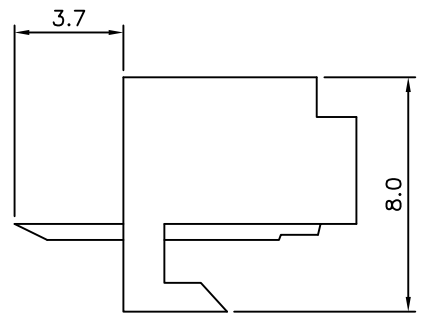
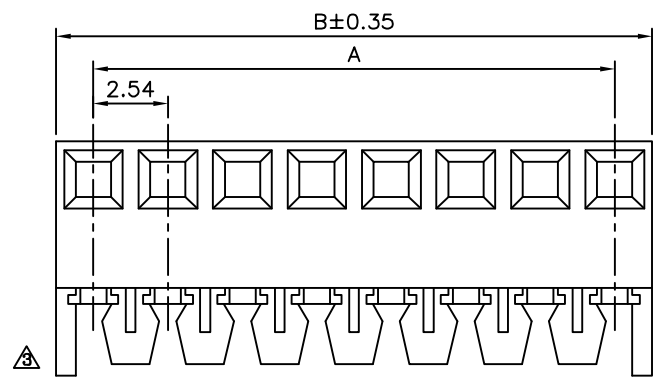

△△ SPECIFICATION

Current:2.5A Max.
 Voltage:250V AC Max.
 Insulation Resistance:1000 Megaohms Min.
 Contact Resistance:20 Milliohms Max.
 Dielectric Withstanding Voltage:1500V AC
 Temperature Range:0°C~+75°C
 Contact:Brass,Tin Plated Over Nickel
 △ Housing:PA66(UL94V-2),White
 RoHS Compliant

Pin	A	B
2	2.54	5.10
3	5.08	7.64
4	7.62	10.18
5	10.16	12.72
6	12.70	15.26
7	15.24	17.80
8	17.78	20.34
9	20.32	22.88
10	22.86	25.42
11	25.40	27.96
12	27.94	30.50
13	30.48	33.04
14	33.02	35.58
15	35.56	38.12
16	38.10	40.66
17	40.64	43.20
18	43.18	45.74
19	45.72	48.28
20	48.26	50.82
21	50.80	53.36
22	53.34	55.90
23	55.88	58.44
24	58.42	60.98
25	60.96	63.52
26	63.50	66.06
27	66.04	68.60
28	68.58	71.14
29	71.12	73.68

4UCON 元化興業股份有限公司
 4UCON TECHNOLOGY INC.

DRAWING No. 05433

APPROVED BY MEI
 CHECKED BY HZF
 DRAWING BY SONG
 REV. A3

UNLESS OTHERWISE SPECIFIED TOLERANCES ARE
 .X ±0.35
 .XX ±0.10
 UNIT mm

NO.	REV.	REVISIONS	CHK	DATE
△A3		Modify Data	HZF	06/27/2013
△A2		Modify Data	HZF	10/13/2011
△A1		Modify Data	HZF	08/12/2009
△A0		NEW RELEASE	HZF	05/02/2006