

Recommended P.C.B. Layout

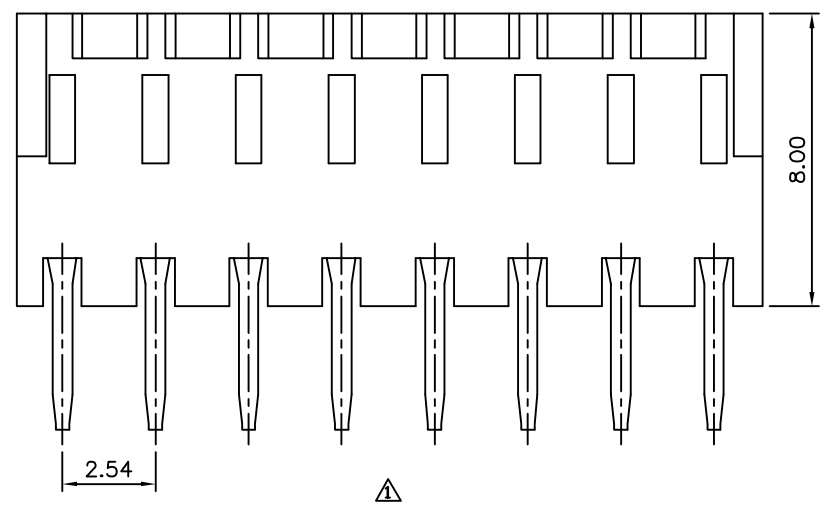
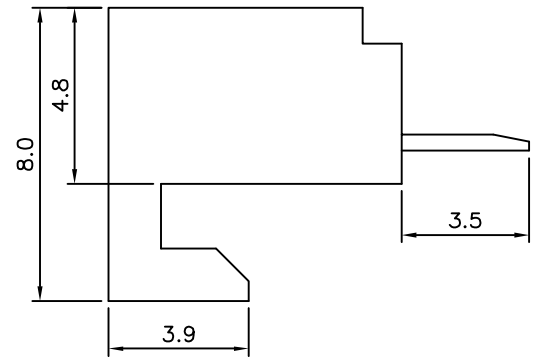
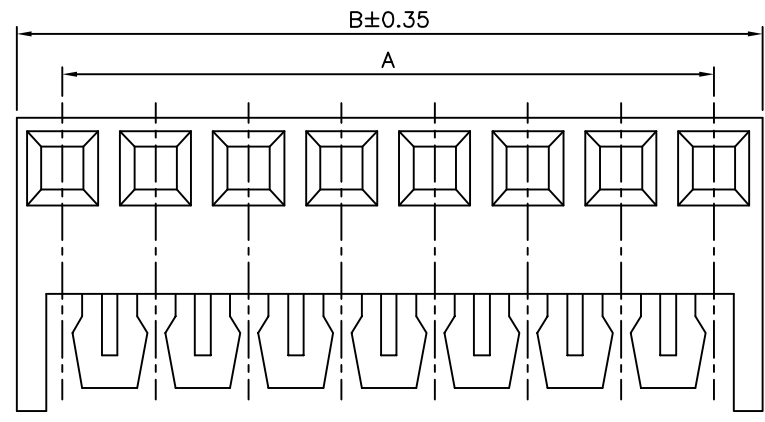

△ SPECIFICATION

Current: 2.5A Max.
 Voltage: 250V AC Max.
 Insulation Resistance: 1000 Megaohms Min.
 Contact Resistance: 20 Milliohms Max.
 Dielectric Withstanding Voltage: 1500V AC
 Temperature Range: 0°C~+75°C
 Solder Resitonce: DIP Connector Terminal Tails In Solder:
 Solder Duration: 5±0.5s
 Solder Temperature: 245±5°C
 Contact: Brass, Tin Plated Over Nickel
 Housing: PA66(UL94V-2), White
 RoHS Compliant

| Pin | A | B | Pin | A | B |
|-----|-------|-------|-----|-------|-------|
| 02 | 2.54 | 5.10 | 16 | 38.10 | 40.66 |
| 03 | 5.08 | 7.64 | 17 | 40.64 | 43.20 |
| 04 | 7.62 | 10.18 | 18 | 43.18 | 45.74 |
| 05 | 10.16 | 12.72 | 19 | 45.72 | 48.28 |
| 06 | 12.70 | 15.26 | 20 | 48.26 | 50.82 |
| 07 | 15.24 | 17.80 | 21 | 50.80 | 53.36 |
| 08 | 17.78 | 20.34 | 22 | 53.34 | 55.90 |
| 09 | 20.32 | 22.88 | 23 | 55.88 | 58.44 |
| 10 | 22.86 | 25.42 | 24 | 58.42 | 60.98 |
| 11 | 25.40 | 27.96 | 25 | 60.96 | 63.52 |
| 12 | 27.94 | 30.50 | 26 | 63.50 | 66.06 |
| 13 | 30.48 | 33.04 | 27 | 66.04 | 68.60 |
| 14 | 33.02 | 35.58 | 28 | 68.58 | 71.14 |
| 15 | 35.56 | 38.12 | 29 | 71.12 | 73.68 |

4UCON 元化興業股份有限公司
 4UCON TECHNOLOGY INC.

| | | | | |
|-------------|--|-------------|--|--|
| DRAWING No. | | APPROVED BY | | UNLESS OTHERWISE SPECIFIED TOLERANCES ARE .X ±0.35 .XX ±0.10 ANG. |
| 05470 | | EMILY | | |
| | | CHECKED BY | | |
| | | HZF | | |
| DRAWING BY | | SONG | | UNIT |
| SCALE | | REV. | | mm |
| NONE | | B2 | | |

| NO. | REV. | REVISIONS | CHK | DATE |
|------|------|-------------|-----|------------|
| △ B2 | | Modify Data | HZF | 01/03/2014 |
| △ B1 | | Modify Data | HZF | 09/08/2011 |
| △ B0 | | NEW RELEASE | HZF | 03/03/2006 |