

**△ SPECIFICATION**

Current Rating:3 Amp  
 Voltage Rating:250V AC/RMS 60Hz  
 Dielectric Withstanding Voltage:  
 1000V AC/RMS 60Hz For 1 Minute  
 Contact Resistance:20 Milliohms Max. At 1 Amp DC  
 Insulation Resistance:1000 Megaohms At 500V DC  
 Insulator:PBT,Black  
 Contact:Phosphor Bronze,Selective Gold Flash  
 Shell:Steel,Tin Plated Over Copper  
 Clinch Nut:Brass,Nickel Plated  
 RoHS Compliant

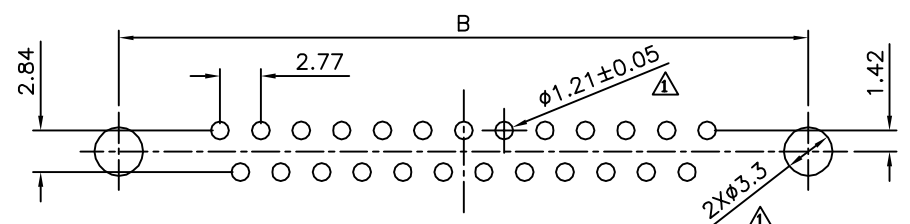

Recommended P.C.B. Layout  
 △ PCB Thickness:2.00;Tolerance±0.05

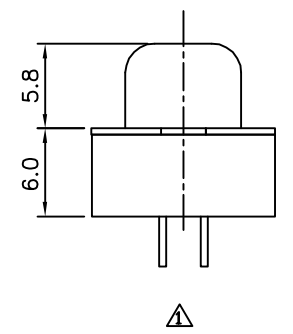
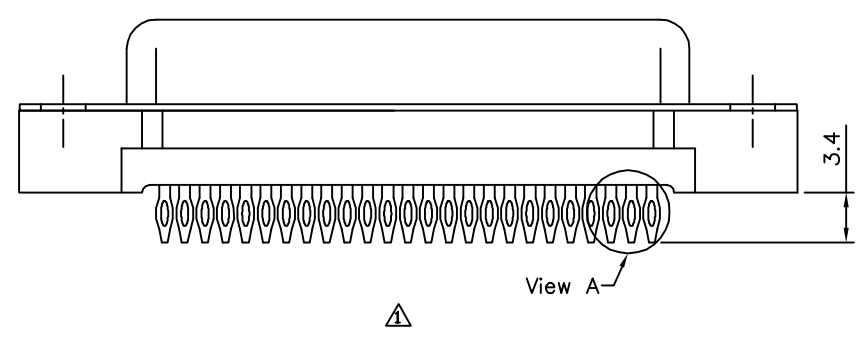
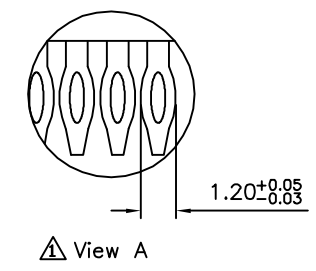
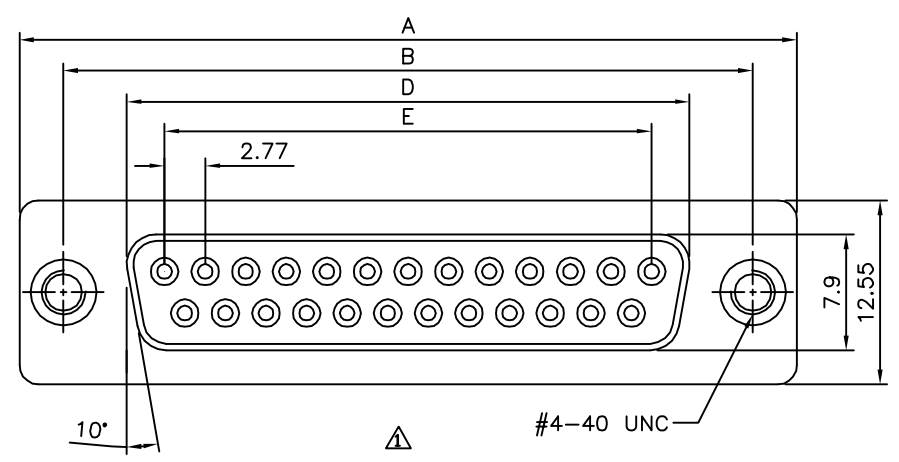

△

| Positions | A     | B     | D     | E     |
|-----------|-------|-------|-------|-------|
| 9         | 30.81 | 24.99 | 16.33 | 11.08 |
| 15        | 39.20 | 33.30 | 24.70 | 19.39 |
| 25        | 53.05 | 47.04 | 38.40 | 33.24 |
| 37        | 69.40 | 63.50 | 54.80 | 49.86 |

**4UCON** 元化興業股份有限公司  
 4UCON TECHNOLOGY INC.

|             |      |             |    |                                                                                                   |
|-------------|------|-------------|----|---------------------------------------------------------------------------------------------------|
| DRAWING No. |      | APPROVED BY |    | UNLESS OTHERWISE SPECIFIED TOLERANCES ARE<br>X. ±0.38 X.* ±3*<br>.X ±0.25 .X.* ±1.0*<br>.XX ±0.13 |
| 07939       |      | MEI         |    |                                                                                                   |
|             |      | CHECKED BY  |    |                                                                                                   |
|             |      | HZF         |    |                                                                                                   |
|             |      | DRAWING BY  |    | UNIT<br>mm                                                                                        |
|             |      | QQJ         |    |                                                                                                   |
| SCALE       | NONE | REV.        | A1 | △                                                                                                 |

|      |      |             |     |            |
|------|------|-------------|-----|------------|
| NO.  | REV. | REVISIONS   | CHK | DATE       |
| △ A1 |      | Modify Data | HZF | 09/13/2010 |
| △ A0 |      | NEW RELEASE |     |            |