

**△ SPECIFICATION**

Current Rating:3 Amp  
 Voltage Rating:250V AC/RMS 60Hz  
 Dielectric Withstanding Voltage:  
 1000V AC/RMS 60Hz For 1 Minute  
 Contact Resistance:20 Milliohms Max. At 1 Amp DC  
 Insulation Resistance:1000 Megaohms At 500V DC  
 Insulator:PBT,Black  
 Contact:Phosphor Bronze,Selective Gold Flash  
 Shell:Steel,Tin Plated Over Copper  
 Clinch Nut:Brass,Nickel Plated  
 RoHS Compliant

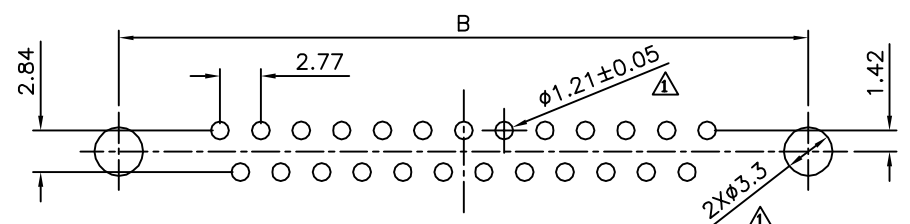

Recommended P.C.B. Layout  
 △ PCB Thickness:2.00;Tolerance±0.05

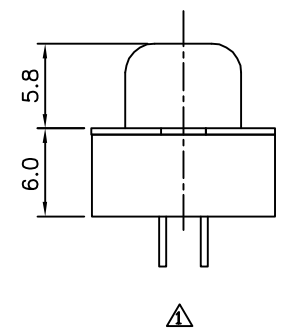
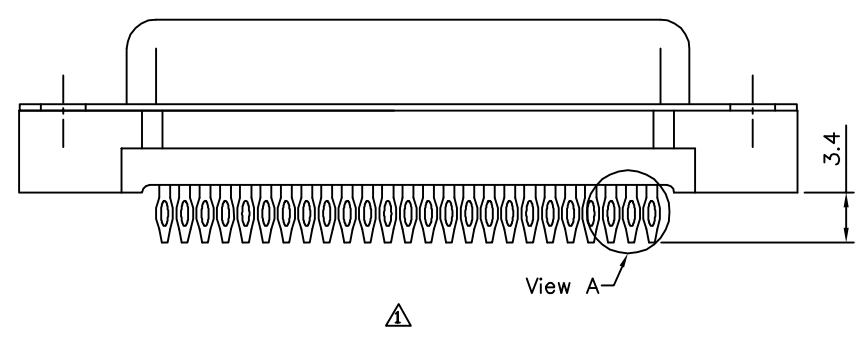
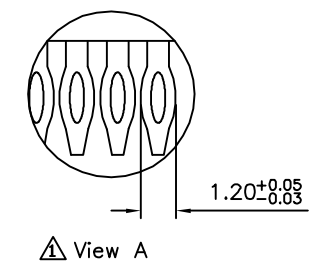
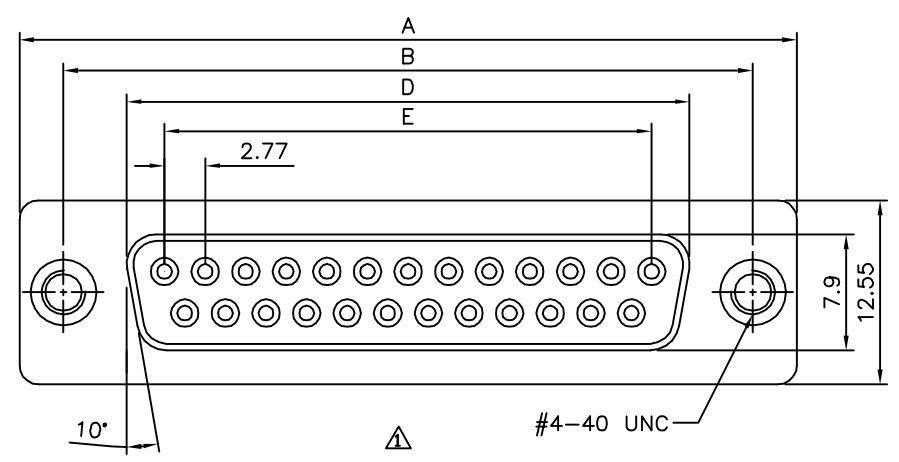

△

Positions	A	B	D	E
9	30.81	24.99	16.33	11.08
15	39.20	33.30	24.70	19.39
25	53.05	47.04	38.40	33.24
37	69.40	63.50	54.80	49.86

**4UCON** 元化興業股份有限公司  
 4UCON TECHNOLOGY INC.

DRAWING No.		APPROVED BY		UNLESS OTHERWISE SPECIFIED TOLERANCES ARE X. ±0.38 X.* ±3* .X ±0.25 .X.* ±1.0* .XX ±0.13
07942		MEI		
		CHECKED BY		
		HZF		
		DRAWING BY		UNIT mm
		QQJ		
SCALE	NONE	REV.	A1	△

NO.	REV.	REVISIONS	CHK	DATE
△ A1		Modify Data	HZF	09/13/2010
△ A0		NEW RELEASE		