

Recommended P.C.B. Layout (Top View)  
(PCB Board Tolerance ±0.05)

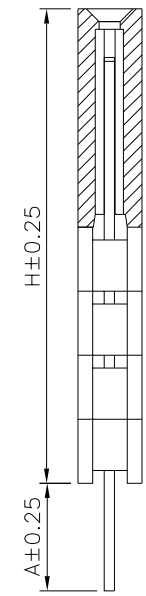
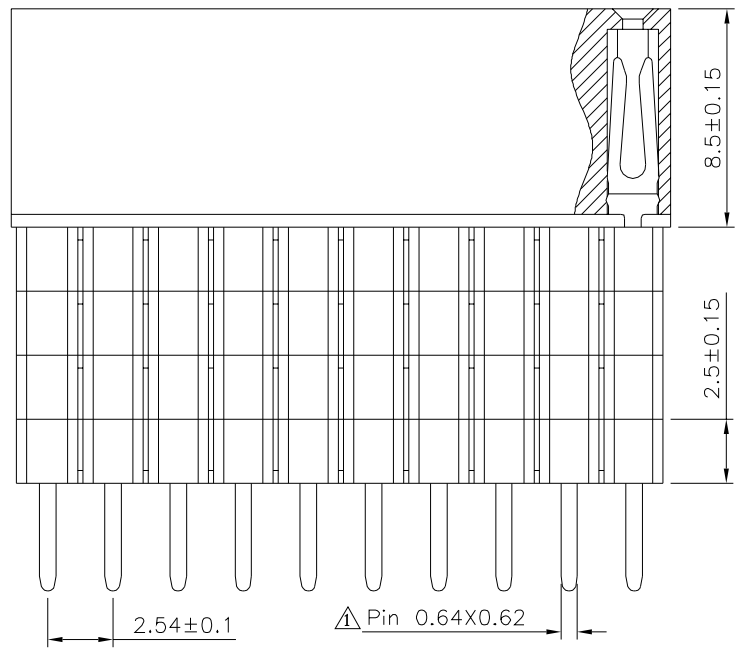
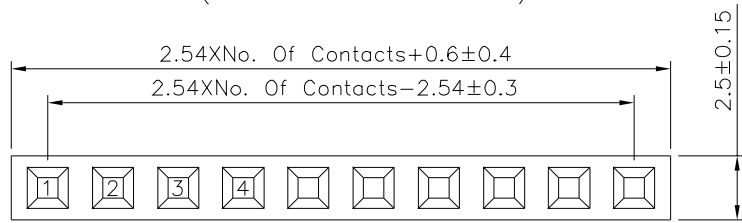

**SPECIFICATION**

Current Rating: 3A  
 Withstand Voltage: 1000V AC Min./Minute  
 Contact Resistance: 20 Milliohms Max.  
 Insulation Resistance: 1000 Megohms Min.  
 Operating Temperature: -40°C ~ +105°C  
 ⚠ Insulator: PA9T(UL94V-0), Black  
 Contact: Brass, Gold Flash Over Nickel  
 RoHS Compliant

Series No.	Plastic Q'ty	H	A
0196	1	11.00	2.30
0196	1	11.00	7.00
0196	1	11.00	12.30
0197	2	13.50	4.50
0197	2	13.50	9.80
0198	3	16.00	2.00
0198	3	16.00	7.30
0199	4	18.50	4.80

**4UCON** 元化興業股份有限公司  
 4UCON TECHNOLOGY INC.

DRAWING No.		APPROVED BY		UNLESS OTHERWISE SPECIFIED TOLERANCES ARE ⚠	
08179		EMILY			
		CHECKED BY			
		HZF			
DRAWING BY		HAO		X: ±0.30 X: ±2° .X ±0.25 .X: ±1.5° .XX ±0.20 .XX: ±1° .XXX ±0.15 .XXX: ±0.5°	
SCALE	NONE	REV.	A1	UNIT	mm

NO.	REV.	REVISIONS	CHK	DATE
⚠	A1	Modify Data	HZF	03/28/2025
⚠	A0	NEW RELEASE	HZF	12/11/2014