

△△△ SPECIFICATION

Current Rating:3 Amp/Contact Max.
 Operation Voltage:60V AC/DC
 Contact Resistance:4 Milliohms/Contact Max.
 Insulation Resistance:1000 Megohms Min. At 100V
 Average Insertion Force With Steel Pin Of
 $\phi 0.43\text{mm}$:<150g
 Average Withdrawal Force With Steel Pin Of
 $\phi 0.43\text{mm}$:>50g Min.
 Operation Temperature:Gold Plated:-55°C~+105°C
 Tin Plated:-40°C~+105°C
 Pin(Outer Sleeve):Brass,Tin Plated Over Nickel
 Clip(Contact 4 Finger):Beryllium Copper,Heat Treated
 Gold Flash Over Nickel
 Insulator:PPS(UL94V-0),Black
 RoHS Compliant

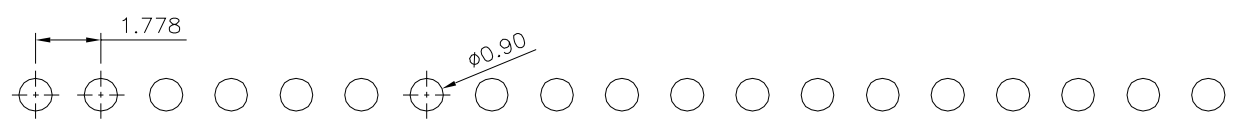

△ Recommended P.C.B. Layout

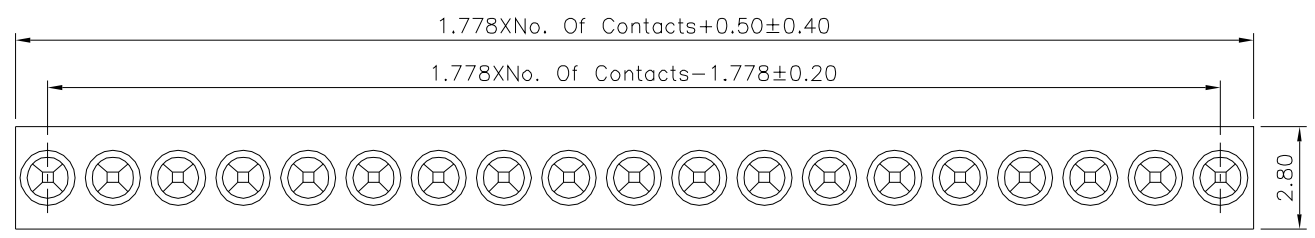

△△

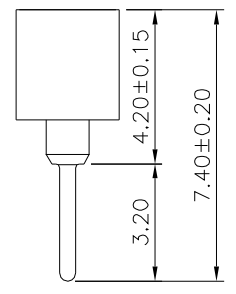
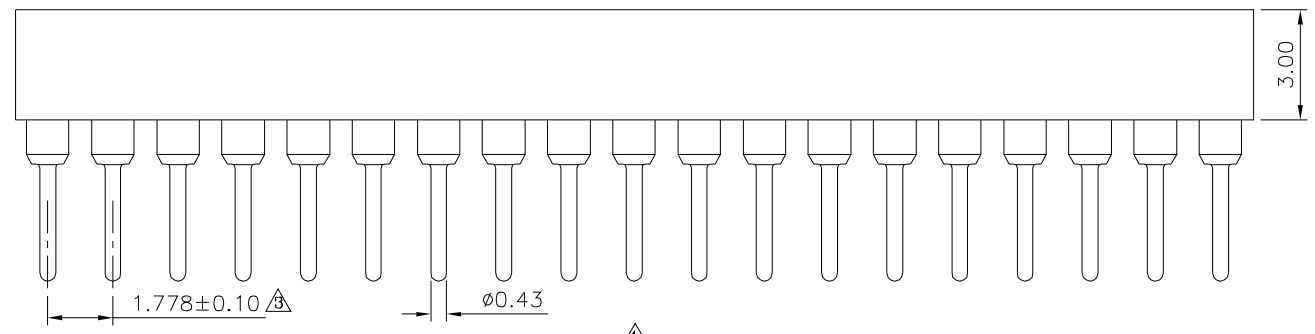

△

4UCON 元化興業股份有限公司
 4UCON TECHNOLOGY INC.

DRAWING No. △△△
 10122

APPROVED BY MEI
 CHECKED BY HZF
 DRAWING BY CYP
 REV. A3

UNLESS OTHERWISE SPECIFIED TOLERANCES ARE
 X. ±0.50
 .X ±0.30
 .XX ±0.20
 .XXX ±0.10
 ANG. ±5°
 UNIT mm

NO.	REV.	REVISIONS	CHK	DATE
△3	A3	Modify Data	HZF	08/30/2019
△2	A2	Modify Data	HZF	06/01/2013
△1	A1	Modify Data	HZF	03/28/2011
△0	A0	NEW RELEASE	HZF	11/04/2005