

**SPECIFICATION**

Current Rating:1.0 Amp  
 Voltage Rating:100V AC/DC  
 Withstand Voltage:500V AC/Minute  
 Contact Resistance:20 Milliohms Max.  
 Insulation Resistance:500 Megaohms Min.  
 Operation Temperature:-25°C~+85°C  
 Insulator:PA9T(UL94V-0),Beige  
 Contact:Brass,Tin Plated Over Nickel  
 RoHS Compliant

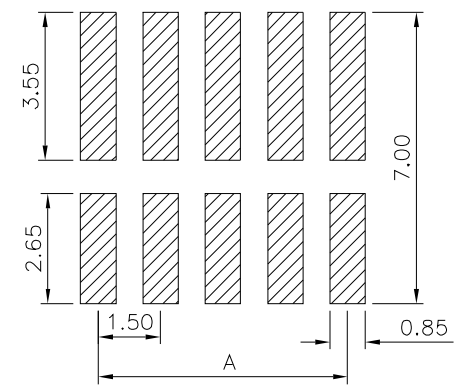

Recommended P.C.B. Layout(Top Side)  
 (PCB Board Tolerance±0.05)

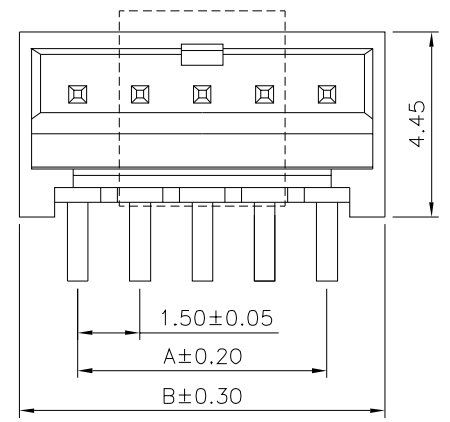
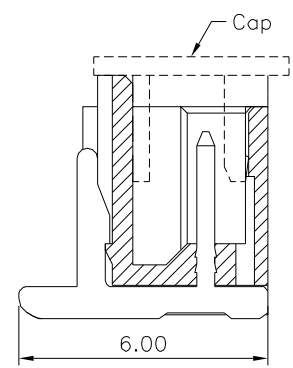
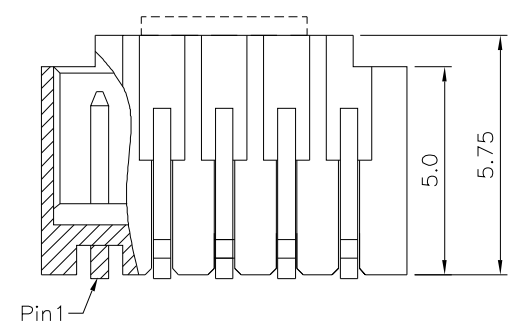

Pin	A	B
02	1.5	4.3
03	3.0	5.8
04	4.5	7.3
05	6.0	8.8
06	7.5	10.3
07	9.0	11.8
08	10.5	13.3
09	12.0	14.8
10	13.5	16.3
11	15.0	17.8
12	16.5	19.3
13	18.0	20.8
14	19.5	22.3
15	21.0	23.8
16	22.5	25.3
17	24.0	26.8
18	25.5	28.3
19	27.0	29.8
20	28.5	31.3

**4UCON** 元化興業股份有限公司  
 4UCON TECHNOLOGY INC.

DRAWING No.		APPROVED BY		UNLESS OTHERWISE SPECIFIED TOLERANCES ARE .X ±0.25 .XX ±0.15 .XXX ±0.10 ANG. ±3°
12007		MEI		
		HZF		
		DRAWING BY		
		CYP		
SCALE	NONE	REV.	A0	UNIT
				mm

NO.	REV.	REVISIONS	CHK	DATE
△ A0		NEW RELEASE	HZF	01/01/2020