

**△△ SPECIFICATION**  
 Current:7.0A Max.  
 Voltage:250V Max.  
 Withstanding Voltage:1500V  
 Insulation Resistance:500K Megaohms Min.  
 Temperature Range:-40°C~+105°C  
 △△ Housing:PA66(UL94V-2),White  
 △△ Contact:Brass,Tin Plated Over Nickel  
 RoHS Compliant

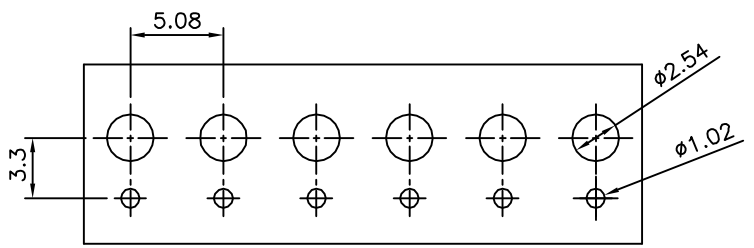

Recommended P.C.B. Layout

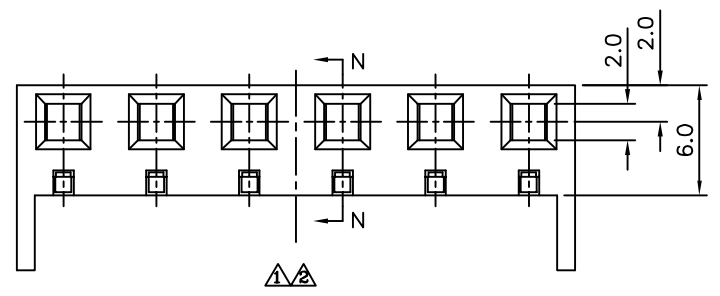

△△

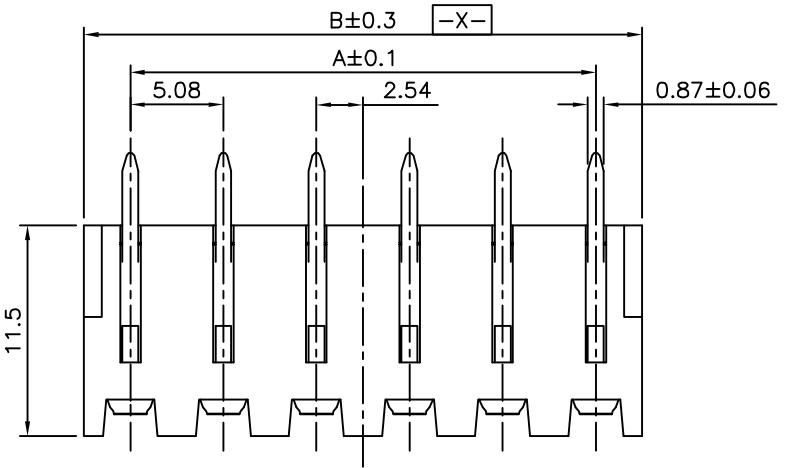

△△

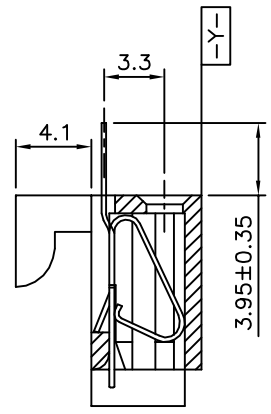

△△ Section:N-N

| △△ Circuit | A     | B     |
|------------|-------|-------|
| 2          | 5.08  | 10.16 |
| 3          | 10.16 | 15.24 |
| 4          | 15.24 | 20.32 |
| 5          | 20.32 | 25.40 |
| 6          | 25.40 | 30.48 |
| 7          | 30.48 | 35.56 |
| 8          | 35.56 | 40.64 |
| 9          | 40.64 | 45.72 |
| 10         | 45.72 | 50.80 |
| 11         | 50.80 | 55.88 |
| 12         | 55.88 | 60.96 |

**4UCON** 元化興業股份有限公司  
 4UCON TECHNOLOGY INC.

DRAWING No. 14929

APPROVED BY MEI  
 CHECKED BY HZF  
 DRAWING BY HAO

UNLESS OTHERWISE SPECIFIED TOLERANCES ARE  
 △.X ±0.30 X.\* ±1\*  
 .XX ±0.20 .X.\* ±0.5\*  
 .XXX ±0.10 .XX.\* ±0.25\*

SCALE NONE

REV. A3

UNIT mm

| NO.   | REV. | REVISIONS   | CHK   | DATE       |
|-------|------|-------------|-------|------------|
| △△ A3 |      | Modify Data | HZF   | 05/20/2015 |
| △△ A2 |      | Modify Data | HZF   | 06/01/2012 |
| △△ A1 |      | Modify Data | HZF   | 05/26/2010 |
| △△ A0 |      | NEW RELEASE | BECKY | 2004/06/07 |