

Recommended P.C.B. Layout (Top Side)
(PCB Board Tolerance ±0.05)

SPECIFICATION
 Current Rating: 2.0 Amp
 Withstand Voltage: 500V AC/DC
 Contact Resistance: 20 Milliohms Max.
 Insulation Resistance: 1000 Megaohms Min.
 Operation Temperature: -40°C ~ +105°C
 Contact: Phosphor Bronze, Gold Plated Over Nickel
 Insulator: PA6T+30%G.F.(UL94V-0), Black
 RoHS Compliant

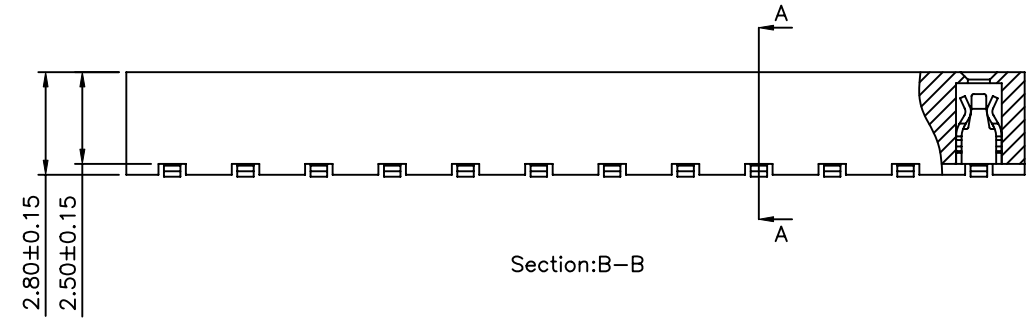

Section: B-B

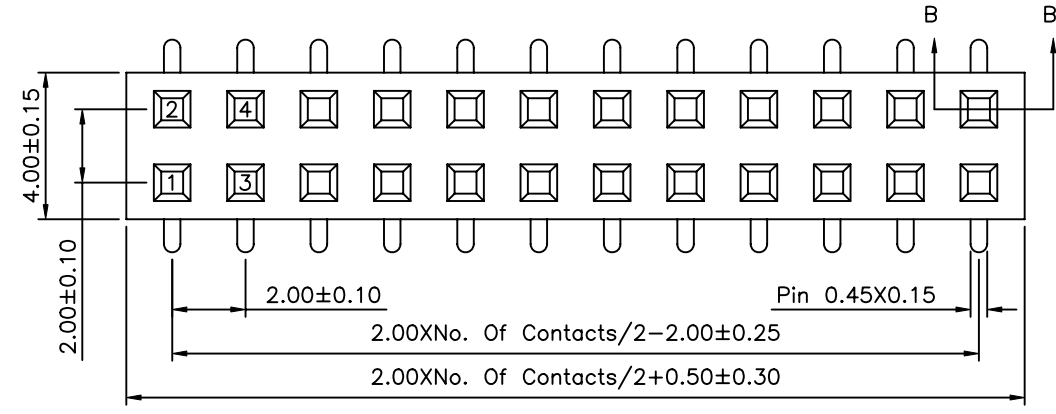
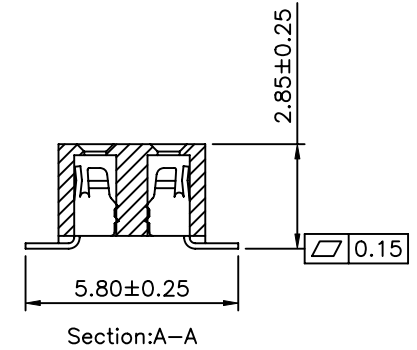

Section: A-A

4UCON 元化興業股份有限公司
 4UCON TECHNOLOGY INC.

DRAWING No.		APPROVED BY		UNLESS OTHERWISE SPECIFIED TOLERANCES ARE .X ±0.40 .XX ±0.25 .XXX ±0.15 ANG. ±3°
16018		MEI		
		HZF		
		DRAWING BY		
		QQJ		
SCALE	NONE	REV.	A0	UNIT mm

△ A0	NEW RELEASE	HZF	06/07/2010
NO. REV.	REVISIONS	CHK	DATE