

Recommended P.C.B Layout

**△ SPECIFICATION**  
 Current:3A  
 Withstanding Voltage:1000V AC RMS  
 Contact Resistance:20 Milliohms Max.  
 Insulation Resistance:1000 Megaohms Min.  
 Operation Temperature:-55°C~+105°C  
 Housing:PBT(UL94V-0),Black  
 △Contact:Brass,Gold Flash Over Nickel  
 No. Of Contacts:02~40 Contacts  
 RoHS Compliant

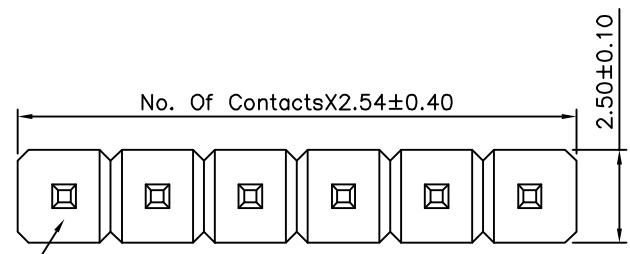

△ Pin 1

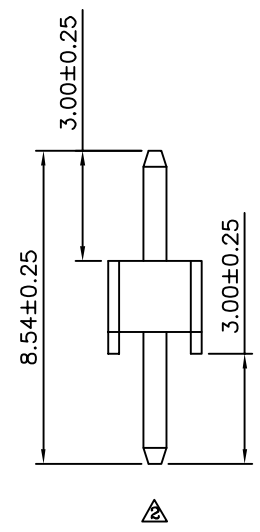
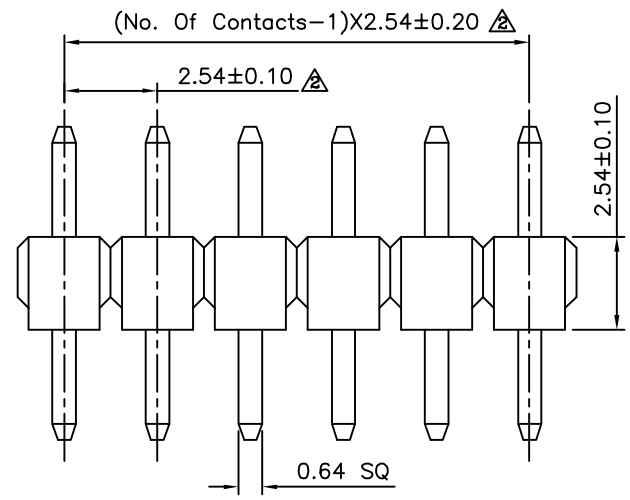

**4UCON** 元化興業股份有限公司  
 4UCON TECHNOLOGY INC.

DRAWING No.		APPROVED BY		UNLESS OTHERWISE SPECIFIED TOLERANCES ARE .X ±0.38 .XX ±0.25 ANG ±5°
17180		EMILY		
		HZF		
		DRAWING BY		UNIT mm
		SONG		
SCALE	NONE	REV.	A2	

NO.	REV.	REVISIONS	CHK	DATE
△ A2		Modify Data	HZF	09/18/2014
△ A1		Modify Data	HZF	04/16/2011
△ A0		NEW RELEASE	EMILY	04/02/2008