

Recommended P.C.B Layout

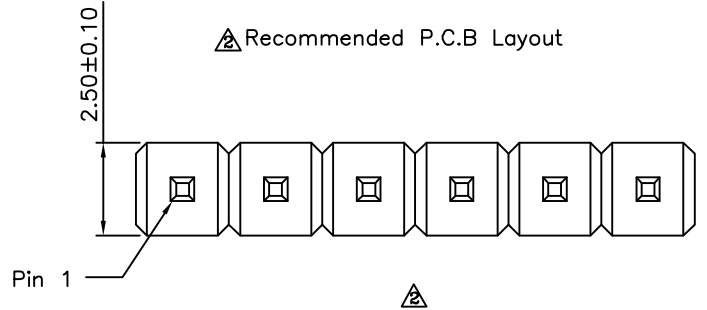

SPECIFICATION

Current:3A
 Withstanding Voltage:1000V AC RMS
 Contact Resistance:20 Milliohms Max.
 Insulation Resistance:1000 Megaohms Min.
 Operation Temperature:-55°C~+105°C
 Insulator:PBT+30%G.F.(UL94V-0),Black
 Contact:Brass,Gold Flash Over Nickel
 No. Of Contacts:2~40 Contacts
 RoHS Compliant

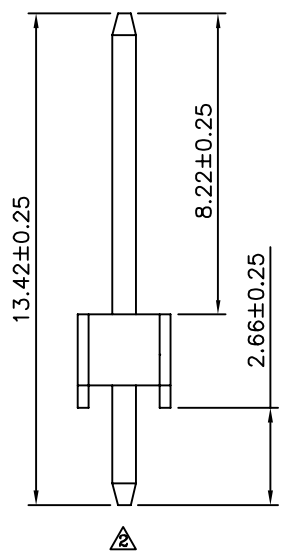
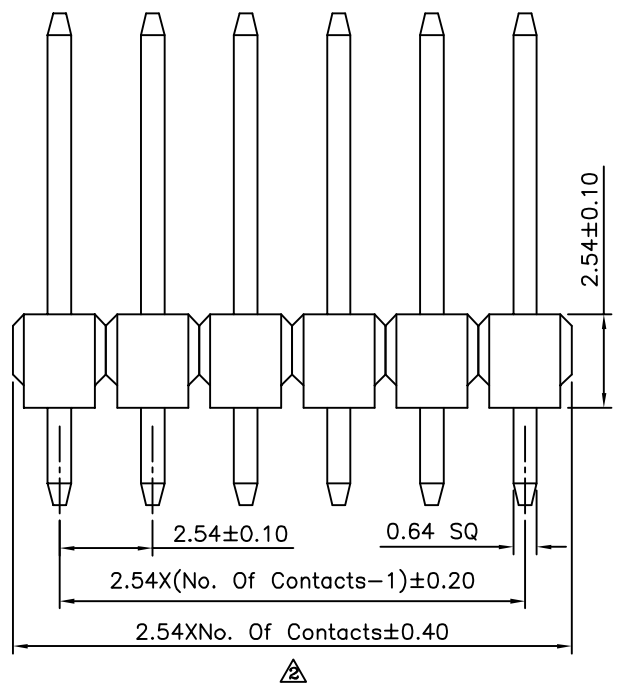

4UCON 元化興業股份有限公司
 4UCON TECHNOLOGY INC.

| | | | | |
|-------------|------|-------------|----|--|
| DRAWING No. | | APPROVED BY | | UNLESS OTHERWISE SPECIFIED TOLERANCES ARE .X ±0.38 .XX ±0.25 ANG. ±5° |
| 17715 | | EMILY | | |
| | | CHECKED BY | | |
| | | HZF | | |
| | | DRAWING BY | | |
| | | CYP | | |
| SCALE | NONE | REV. | A3 | UNIT mm |

| NO. | REV. | REVISIONS | CHK | DATE |
|-----|------|-------------|------|------------|
| A3 | | Modify Data | HZF | 08/28/2015 |
| A2 | | Modify Data | HZF | 09/07/2012 |
| A1 | | Modify Data | HZF | 11/13/2008 |
| A0 | | NEW RELEASE | SHIN | 03/14/2006 |