

Recommended P.C.B Layout(Top Side)  
P.C.B Thickness=1.20~1.60mm(Tolerance=±0.05)

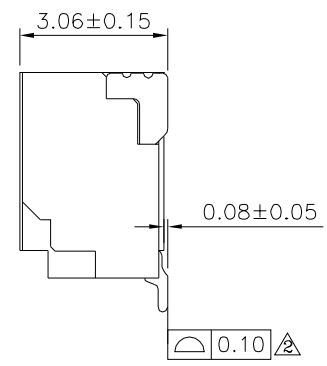
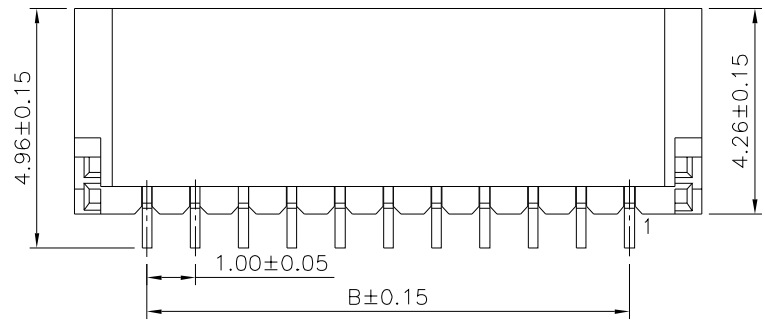
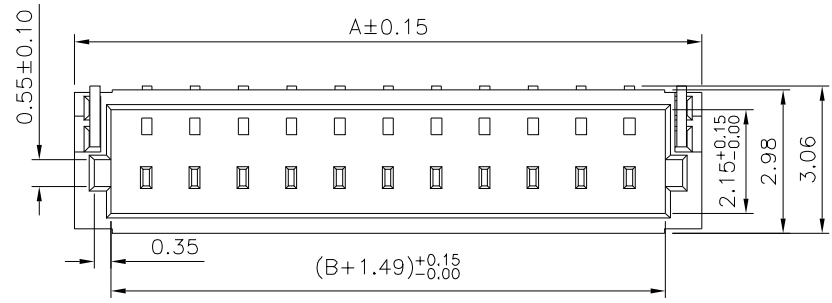

**SPECIFICATION**

- Current Rating:1A AC/DC
- Voltage Rating:50V AC/DC
- Withstanding Voltage:500V AC/Minute
- Contact Resistance:20 Milliohms Max.
- Insulation Resistance:500 Megaohms Min.
- Temperature Range:-25°C~+85°C
- Insulator:PA9T(UL94V-0),Black
- Terminal:Brass,Tin Plated Over Nickel
- Fixed Slice:Brass,Tin Plated Over Nickel
- RoHS Compliant

Pin	A	B	Pin	A	B
2	4.00	1.00	12	14.00	11.00
3	5.00	2.00	13	15.00	12.00
4	6.00	3.00	14	16.00	13.00
5	7.00	4.00	15	17.00	14.00
6	8.00	5.00	16	18.00	15.00
7	9.00	6.00	17	19.00	16.00
8	10.00	7.00	18	20.00	17.00
9	11.00	8.00	19	21.00	18.00
10	12.00	9.00	20	22.00	19.00
11	13.00	10.00			

**4UCON** 元化興業股份有限公司  
4UCON TECHNOLOGY INC.

DRAWING No. 20989

APPROVED BY MEI  
CHECKED BY HZF  
DRAWING BY HAO  
SCALE NONE  
REV. B3

UNLESS OTHERWISE SPECIFIED TOLERANCES ARE  
.X ±0.25  
.XX ±0.20 .X\* ±2\*  
.XXX ±0.10 .XX\* ±1\*  
UNIT mm

NO.	REV.	REVISIONS	CHK	DATE
3	B3	Modify Data	HZF	08/21/2015
2	B2	Modify Data	HZF	04/24/2015
1	B1	Modify Data	HZF	03/22/2013
0	B0	NEW RELEASE	HZF	05/02/2011