

Recommended P.C.B. Layout

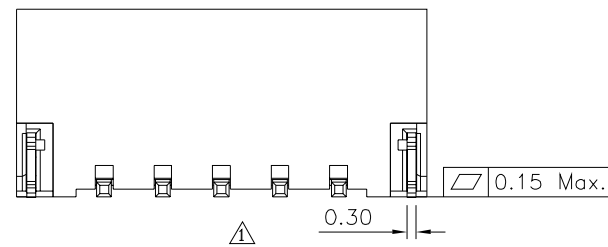
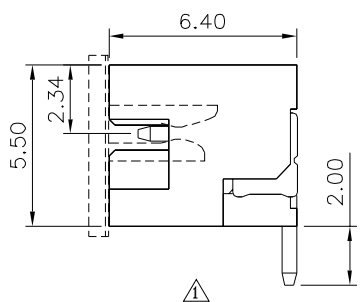
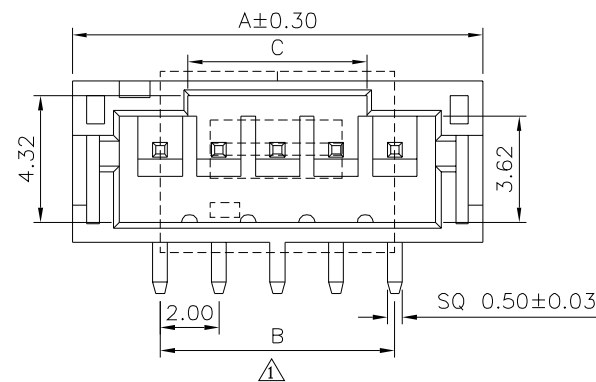
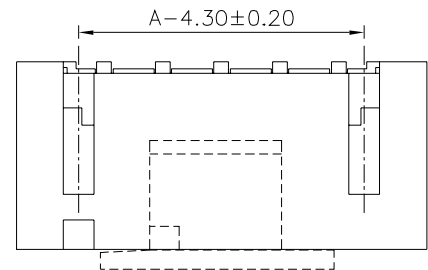

SPECIFICATION
 Current Rating:2A AC/DC
 Voltage Rating:100V AC/DC
 Withstand Voltage:800V AC/Minute
 △ Contact Resistance:20 Milliohms Max.
 Insulation Resistance:1000 Megaohms Min.
 Temperature Range:-25°C~+85°C
 Insulator:PA9T(UL94V-0)
 Contact:Brass,Tin Plated Over Nickel
 Solder Nail:Brass,Tin Plated Over Nickel
 RoHS Compliant

△ Pin	A	B	C	D
02	8.00	2.00	1.10	4.80
03	10.00	4.00	2.10	6.80
04	12.00	6.00	4.10	8.80
05	14.00	8.00	6.10	10.80
06	16.00	10.00	8.10	12.80
07	18.00	12.00	10.10	14.80
08	20.00	14.00	12.10	16.80
09	22.00	16.00	14.10	18.80
10	24.00	18.00	16.10	20.80
11	26.00	20.00	18.10	22.80
12	28.00	22.00	20.10	24.80
13	30.00	24.00	22.10	26.80
14	32.00	26.00	24.10	28.80
15	34.00	28.00	26.10	30.80
16	36.00	30.00	28.10	32.80

4UCON 元化興業股份有限公司
 4UCON TECHNOLOGY INC.

DRAWING No.		APPROVED BY		UNLESS OTHERWISE SPECIFIED TOLERANCES ARE .X ±0.30 X° ±1° .XX ±0.20 .XXX ±0.10
22039		MEI		
		CHECKED BY		
		HZF		
		DRAWING BY		
		CYP		
SCALE	NONE	REV.	A1	UNIT
				mm

△ A1	Modify Data	HZF	10/17/2018
△ A0	NEW RELEASE	HZF	05/30/2014
NO. REV.	REVISIONS	CHK	DATE