

Recommended P.C.B. Layout

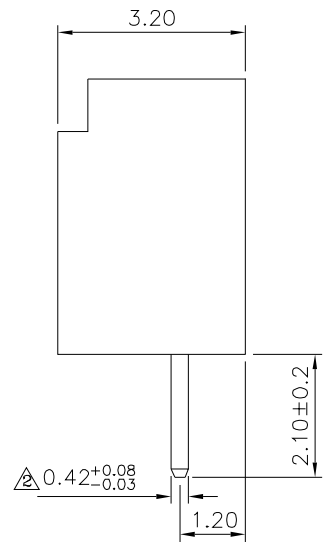
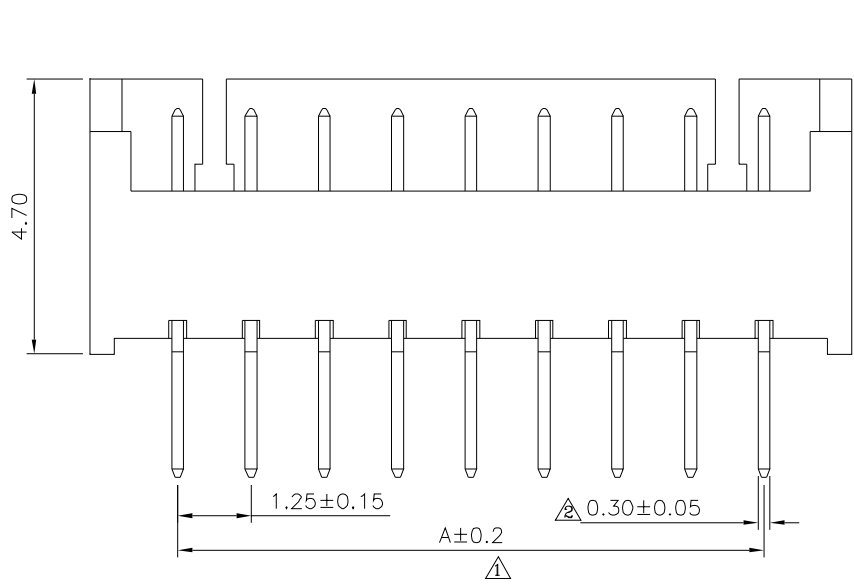
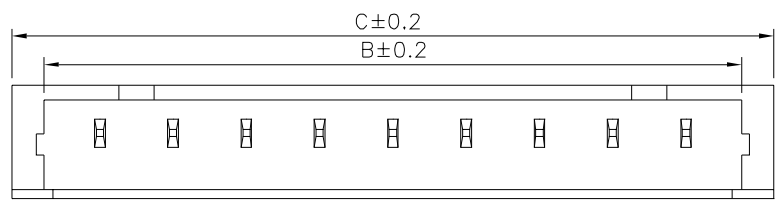

SPECIFICATION

Current Rating:1A AC,DC  
 Voltage Rating:125V AC,DC  
 Withstand Voltage:250V AC/Minute  
 Contact Resistance:20 Milliohms Max.  
 Insulation Resistance:100 Megaohms Min.  
 Temperature Range:-40°C~+105°C  
 Insulator:LCP(UL94V-0),Beige  
 Contact:Brass,Tin Plated Over Nickel  
 RoHS Compliant

Pin	A	B	C
02	1.25	3.15	4.25
03	2.50	4.40	5.50
04	3.75	5.65	6.75
05	5.00	6.90	8.00
06	6.25	8.15	9.25
07	7.50	9.40	10.50
08	8.75	10.65	11.75
09	10.00	11.90	13.00
10	11.25	13.15	14.25
11	12.50	14.40	15.50
12	13.75	15.65	16.75
13	15.00	16.90	18.00
14	16.25	18.15	19.25
15	17.50	19.40	20.50
16	18.75	20.65	21.75

**4UCON** 元化興業股份有限公司  
 4UCON TECHNOLOGY INC.

DRAWING No.		APPROVED BY		UNLESS OTHERWISE SPECIFIED TOLERANCES ARE .X ±0.30 .XX ±0.20 .XXX ±0.10 ANG. ±3°
22723		MEI		
		CHECKED BY	HZF	
		DRAWING BY	CYP	
SCALE	NONE	REV.	A4	UNIT mm

NO.	REV.	REVISIONS	CHK	DATE
△A4		Modify Data	HZF	10/15/2021
△A3		Modify Data	HZF	08/16/2021
△A2		Modify Data	HZF	01/22/2019
△A1		Modify Data	HZF	07/21/2015
△A0		NEW RELEASE	HZF	07/20/2014