

Recommended P.C.B. Layout

**SPECIFICATION**  
 ⚠ Current Rating: 3A AC/DC  
 Voltage Rating: 250V AC Max.  
 Dielectric Withstanding Voltage: 800V AC/Minute  
 Contact Resistance: 10 Milliohms Max.  
 Insulation Resistance: 1000 Megaohms Min.  
 Operating Temperature: -25°C~+85°C  
 Terminal: Brass, Tin Plated Over Copper  
 ⚠ Insulator: PA66(UL94V-0), White  
 RoHS Compliant

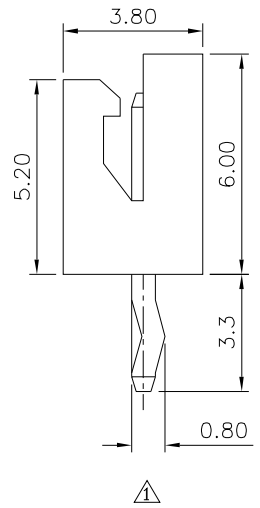
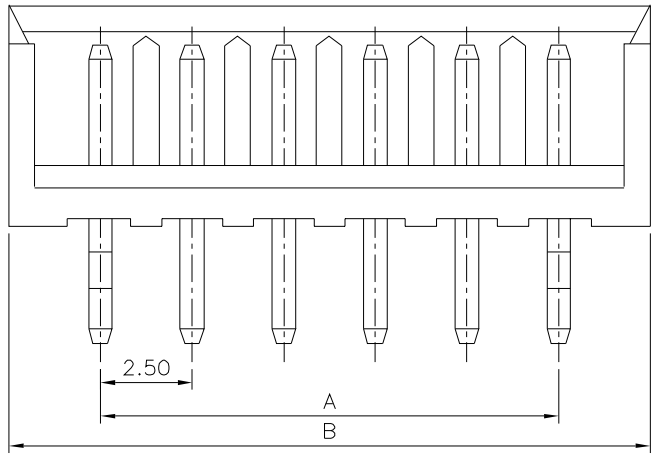
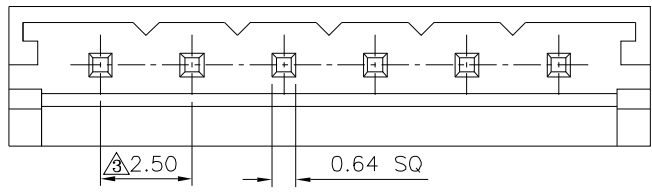

| Pin | A     | B     |
|-----|-------|-------|
| 02  | 2.50  | 7.50  |
| 03  | 5.00  | 10.00 |
| 04  | 7.50  | 12.50 |
| 05  | 10.00 | 15.00 |
| 06  | 12.50 | 17.50 |
| 07  | 15.00 | 20.00 |
| 08  | 17.50 | 22.50 |
| 09  | 20.00 | 25.00 |
| 10  | 22.50 | 27.50 |
| 11  | 25.00 | 30.00 |
| 12  | 27.50 | 32.50 |

**4UCON** 元化興業股份有限公司  
 4UCON TECHNOLOGY INC.

|                |      |                |    |  |
|----------------|------|----------------|----|--|
| DRAWING No.    |      | APPROVED BY    |    | UNLESS OTHERWISE SPECIFIED TOLERANCES ARE<br>.X ±0.3<br>.XX ±0.2 |
| 02564          |      | MEI            |    |  |
|                |      | CHECKED BY HZF |    |  |
| DRAWING BY HAO |      | A3             |    |  |
| SCALE          | NONE | REV.           | A3 | UNIT mm  |

| NO. | REV. | REVISIONS   | CHK | DATE       |
|-----|------|-------------|-----|------------|
| ⚠   | A3   | Modify Data | HZF | 08/12/2015 |
| ⚠   | A2   | Modify Data | HZF | 05/11/2012 |
| ⚠   | A1   | Modify Data | HZF | 07/31/2010 |
| ⚠   | A0   | NEW RELEASE | HZF | 06/05/2007 |