

SPECIFICATION
 Current Rating:3A AC/DC
 Voltage Rating:250V AC Max.
 Withstanding Voltage:1000V AC/Minute
 Contact Resistance:20 Milliohms Max.
 Insulation Resistance:1000 Megaohms Min.
 Operation Temperature:-25°C~+85°C
 Terminal:Brass,Tin Plated
 Insulator:PA66(UL94V-2),Natural
 RoHS Compliant

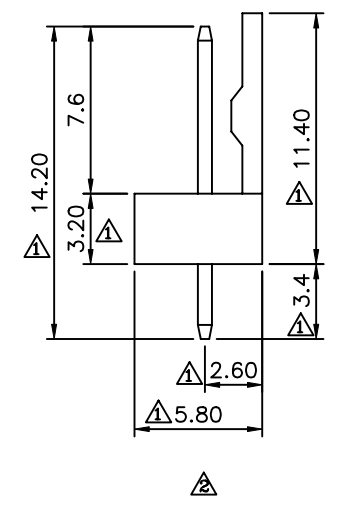
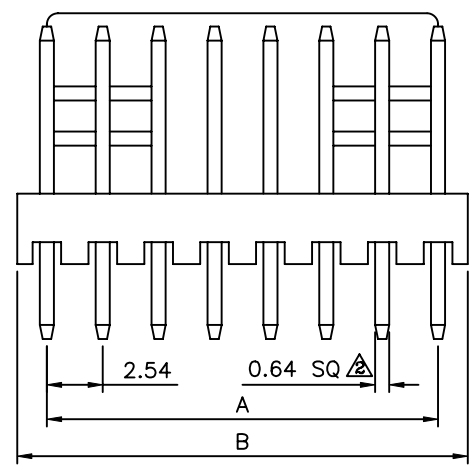
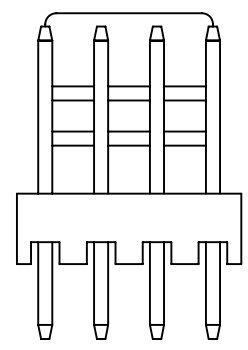
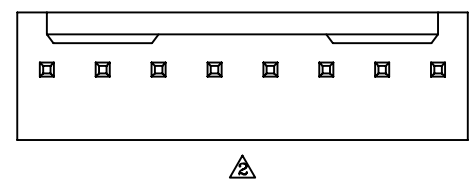
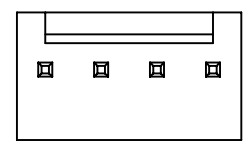

(2 Through 5 Circuits)

(6 Through 20 Circuits)

| Poles | A | B |
|-------|-------|-------|
| 2 | 2.54 | 5.12 |
| 3 | 5.08 | 7.66 |
| 4 | 7.62 | 10.20 |
| 5 | 10.16 | 12.74 |
| 6 | 12.70 | 15.30 |
| 7 | 15.24 | 17.94 |
| 8 | 17.78 | 20.48 |
| 9 | 20.32 | 23.02 |
| 10 | 22.86 | 25.58 |
| 11 | 25.40 | 28.12 |
| 12 | 27.94 | 30.68 |
| 13 | 30.48 | 33.10 |
| 14 | 33.02 | 35.80 |
| 15 | 35.56 | 38.34 |
| 16 | 38.10 | 40.94 |
| 17 | 40.64 | 43.30 |
| 18 | 43.18 | 45.90 |
| 19 | 45.72 | 48.56 |
| 20 | 48.26 | 50.80 |

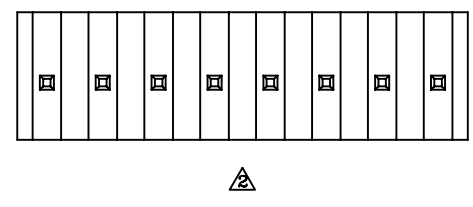

4UCON 元化興業股份有限公司
 4UCON TECHNOLOGY INC.

| | | | | |
|-------------|------|----------------|----|--|
| DRAWING No. | | APPROVED BY | | UNLESS OTHERWISE SPECIFIED TOLERANCES ARE .X ±0.35 .XX ±0.25 |
| 01967 | | MEI | | |
| | | CHECKED BY HZF | | |
| | | DRAWING BY QQJ | | |
| SCALE | NONE | REV. | A2 | UNIT mm |

| | | | | |
|-----|------|---------------|-------|------------|
| NO. | REV. | REVISIONS | CHK | DATE |
| | A2 | Modify Data | HZF | 08/21/2010 |
| | A1 | Add Tolerance | BECKY | 2005/05/12 |
| | A0 | NEW RELEASE | BECKY | |